



SUPPLÉMENT TECHNIQUE

Édition 1, 2022

www.variant-industrial.pl

 **VARIANT**
INDUSTRIAL



CONTENU

- 4 Types de systèmes
- 5 Les types des croisillons
- 6 Types des tirants
- 8 Hauteurs de poignée
- 9 Types de poignées
- 10 Porte coulissante montage au mur
- 11 Porte coulissante loft art au mur
- 12 Porte coulissante ave un imposte fixe latérale
- 13 Porte coulissante avec un imposte horizontale
- 14 Système de porte coulissante
- 15 Porte coulissante a galendage
- 16 Porte battante
- 18 Porte battante /un ensemble
- 19 La double porte battante /deux vantaux
- 20 La double porte battante /un ensemble
- 22 Porte pivotante
- 23 Porte pliante sans seuil
- 24 Porte pliante avec un seuil
- 25 Installation d'un parois /mur fixe
- 26 Montage des portes battantes
- 27 Montage des portes battantes avec un imposte latérale et avec des impostes horizontaux
- 28 Assemblage des angles de l'ext
- 29 Types d'émaillage
- 30 Nos projets - photos

TYPES DE SYSTÈMES

Loft 20

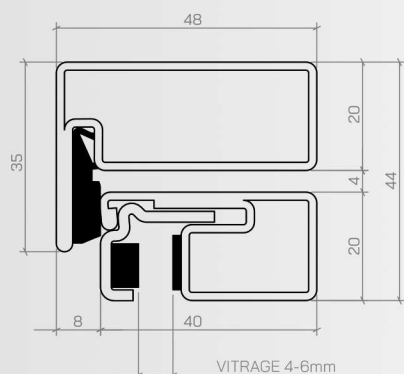

Loft 25

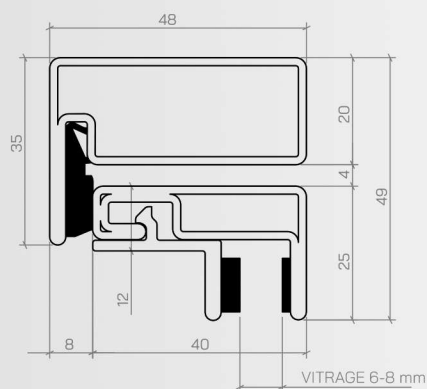

Loft 35

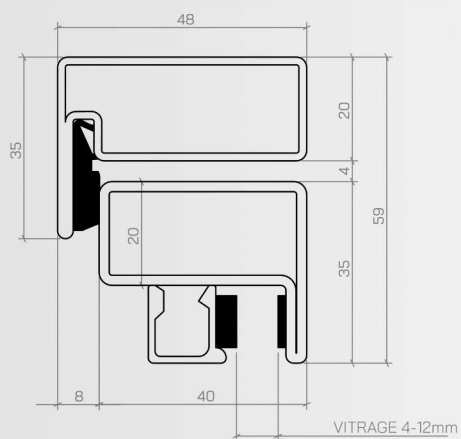

LES TYPES DES CROISILLONS

CROISILLON SOUDÉ
D'UN CÔTÉ 20mm | LOFT 20

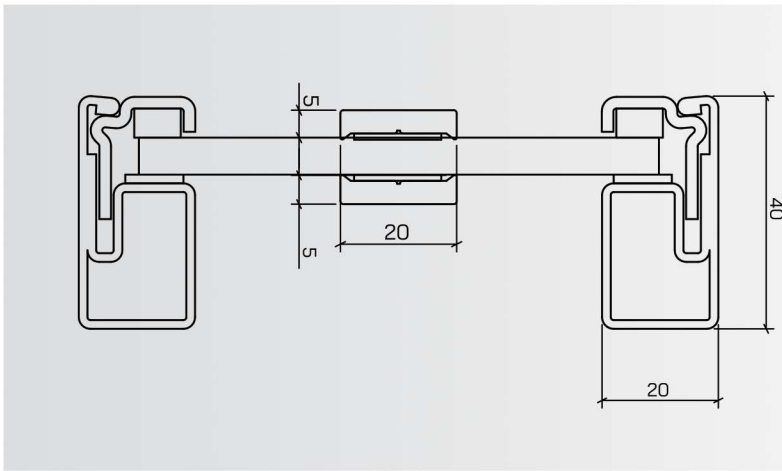

CROISILLONS COLLÉS 20mm
LOFT 20

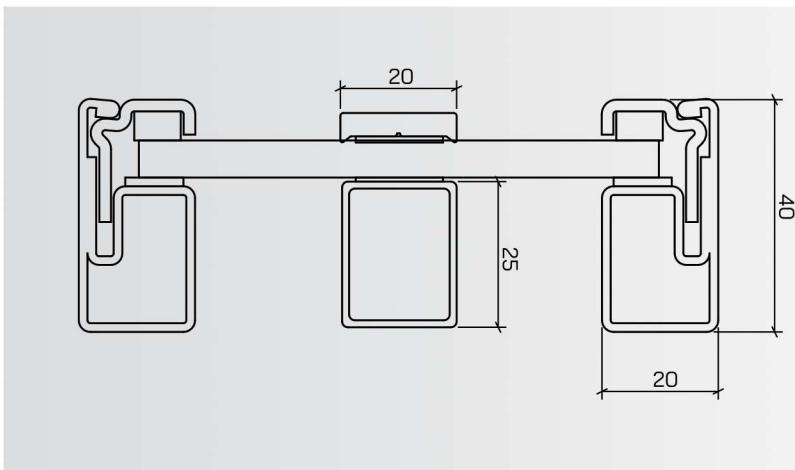

CROISILLONS COLLÉS 40mm LOFT20

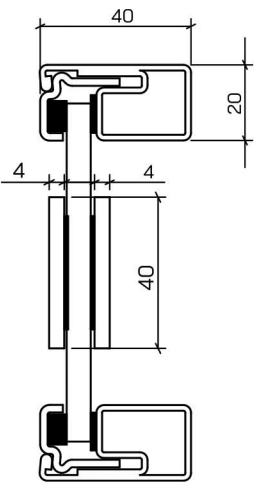

CROISILLONS COLLÉS 20mm LOFT 35

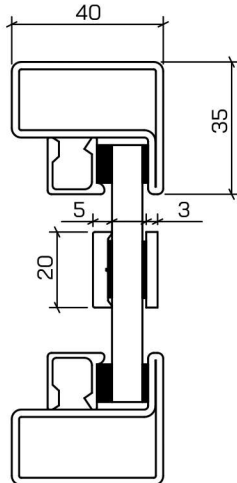

CROISILLONS COLLÉS 20mm LOFT 25

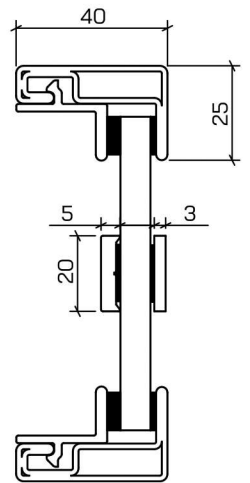

■ TYPES DES TIRANTS

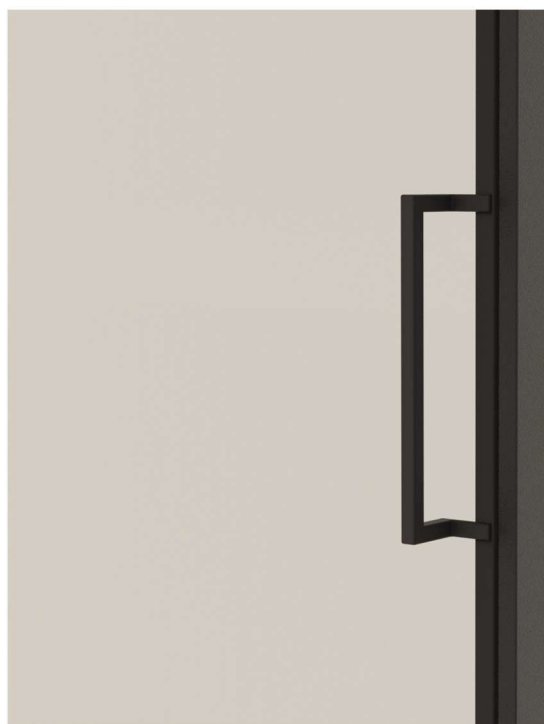

Premium mini (300 mm)

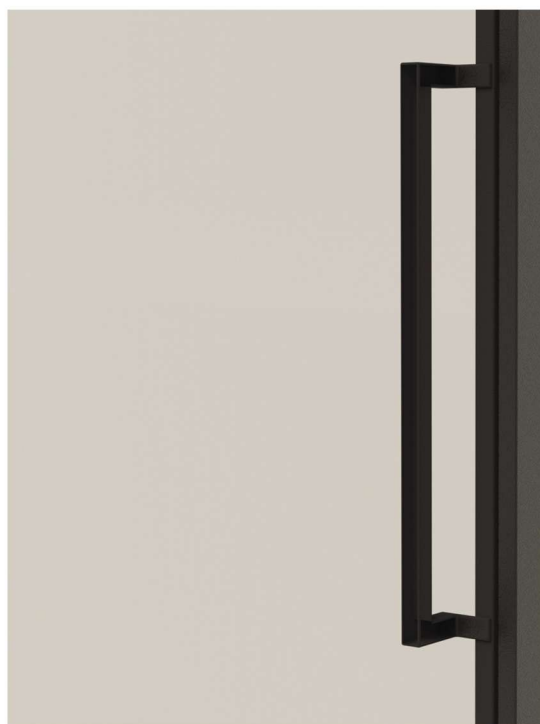

Premium (500 mm)



Standard 20 (200 mm)



Standard 50 (500 mm)

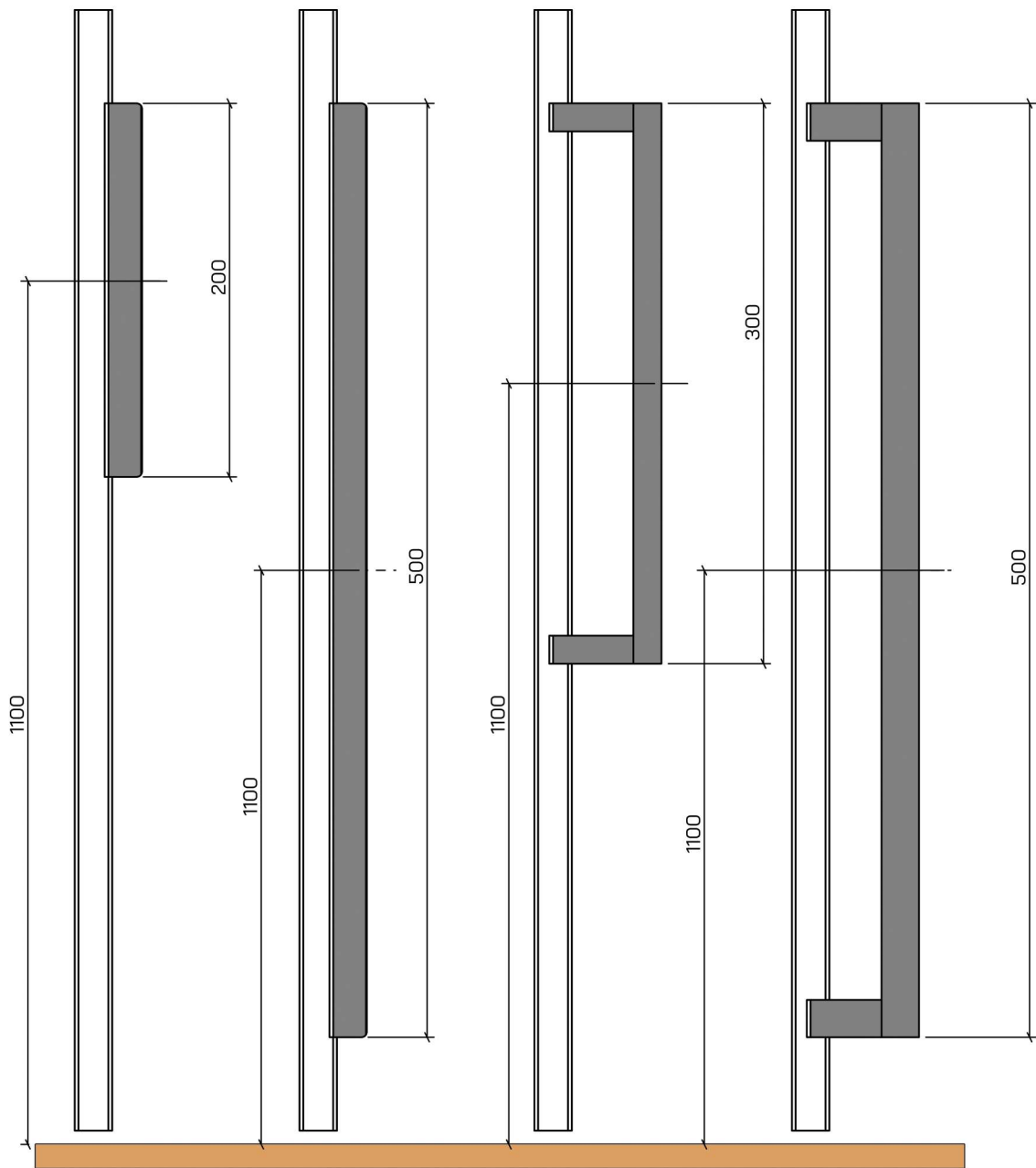

Standard

Standard 50

Premium mini

Premium

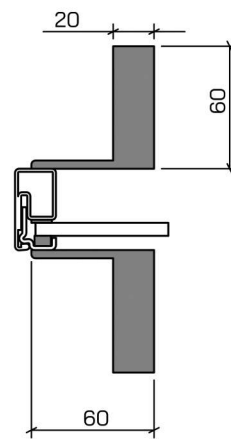
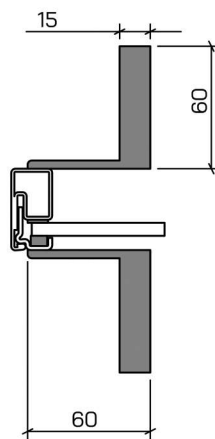
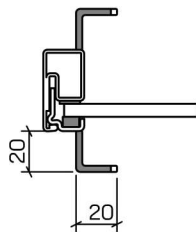
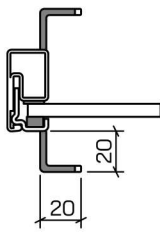

HAUTEURS DE POIGNÉE

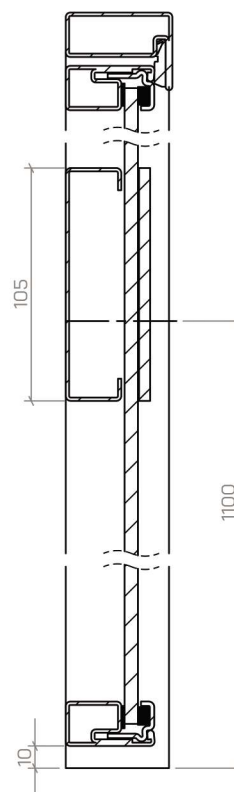
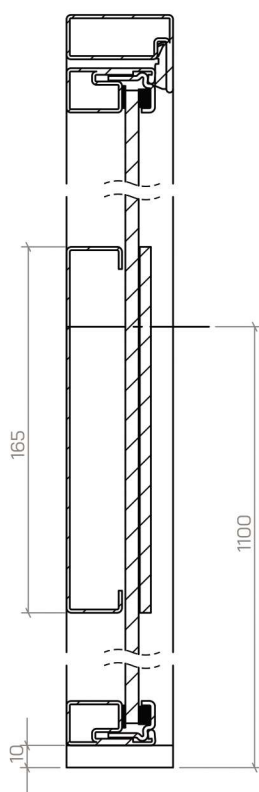
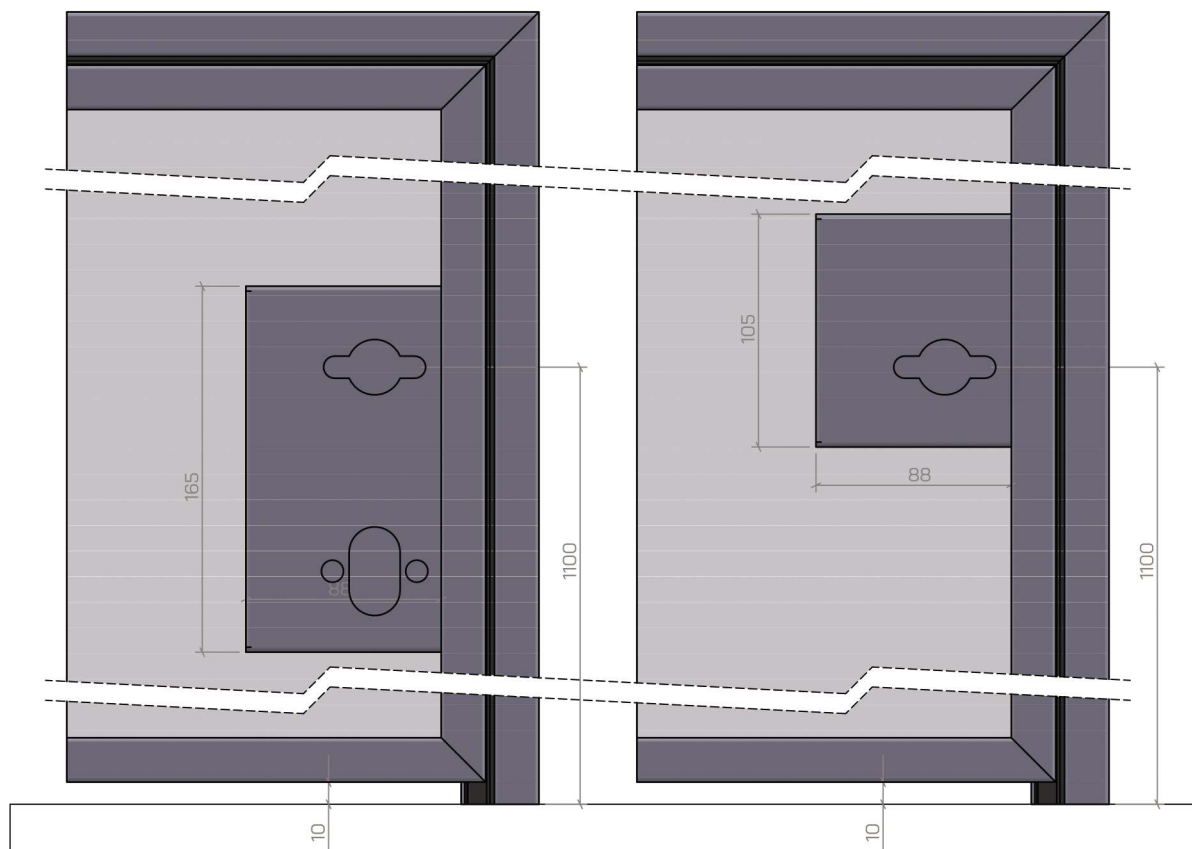

TYPES DE POIGNÉES

Poignée carrée
NOIR, BLANC, ACIER INOXY



Poignée de toilette carrée
NOIR, BLANC, ACIER INOXY



Poignée carrée avec serrure
NOIR, BLANC, ACIER INOXY



Poignée LOFT

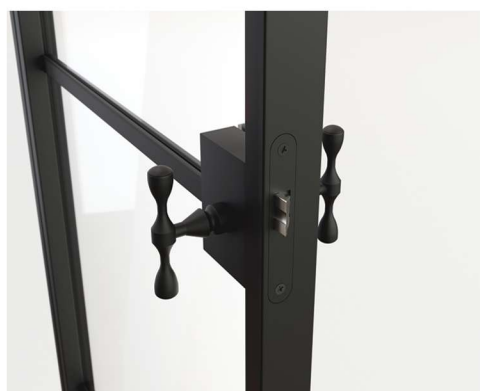

Poignée MODERNE



Poignée ronde
NOIR, BLANC, ACIER INOXY



Poignée ronde avec serrure
NOIR, BLANC, ACIER INOXY



Poignée de toilette ronde avec serrure
NOIR, BLANC, ACIER INOXY



PORTE COULISSANTE

Montage au mur

Sans distance

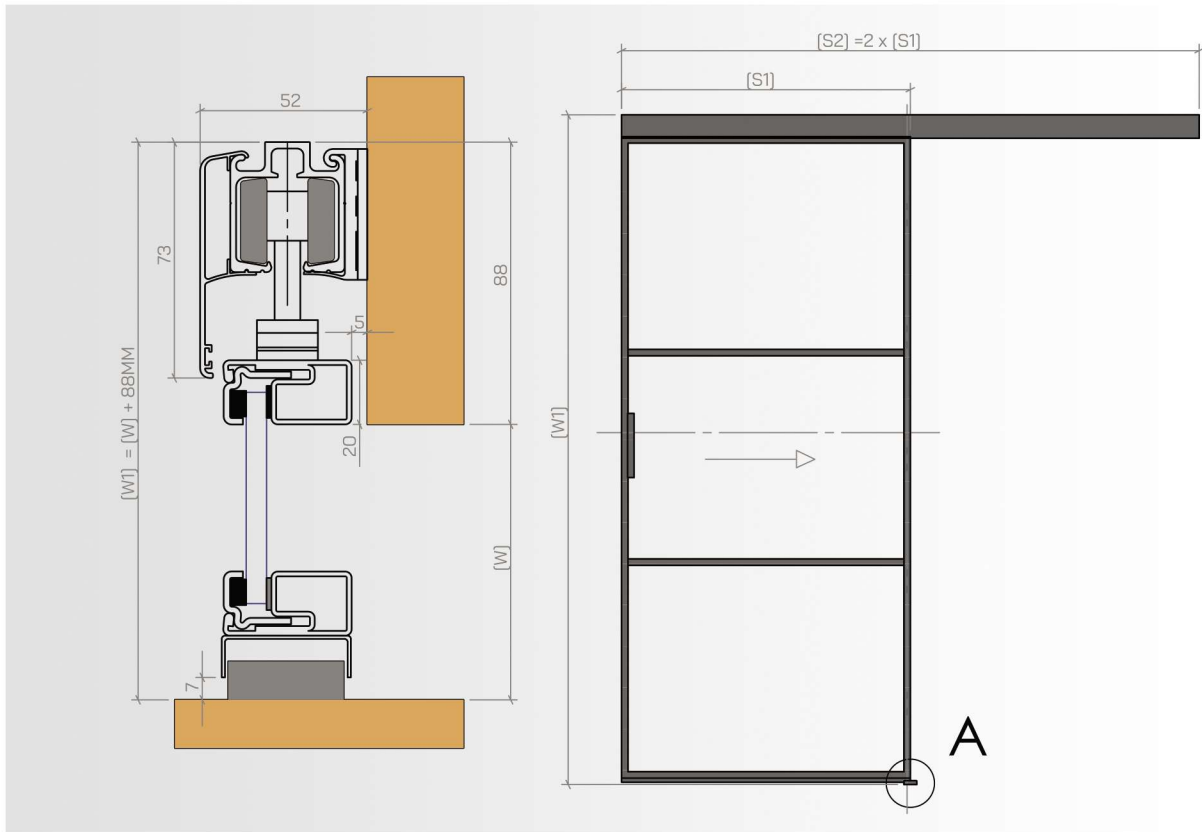

Avec distance

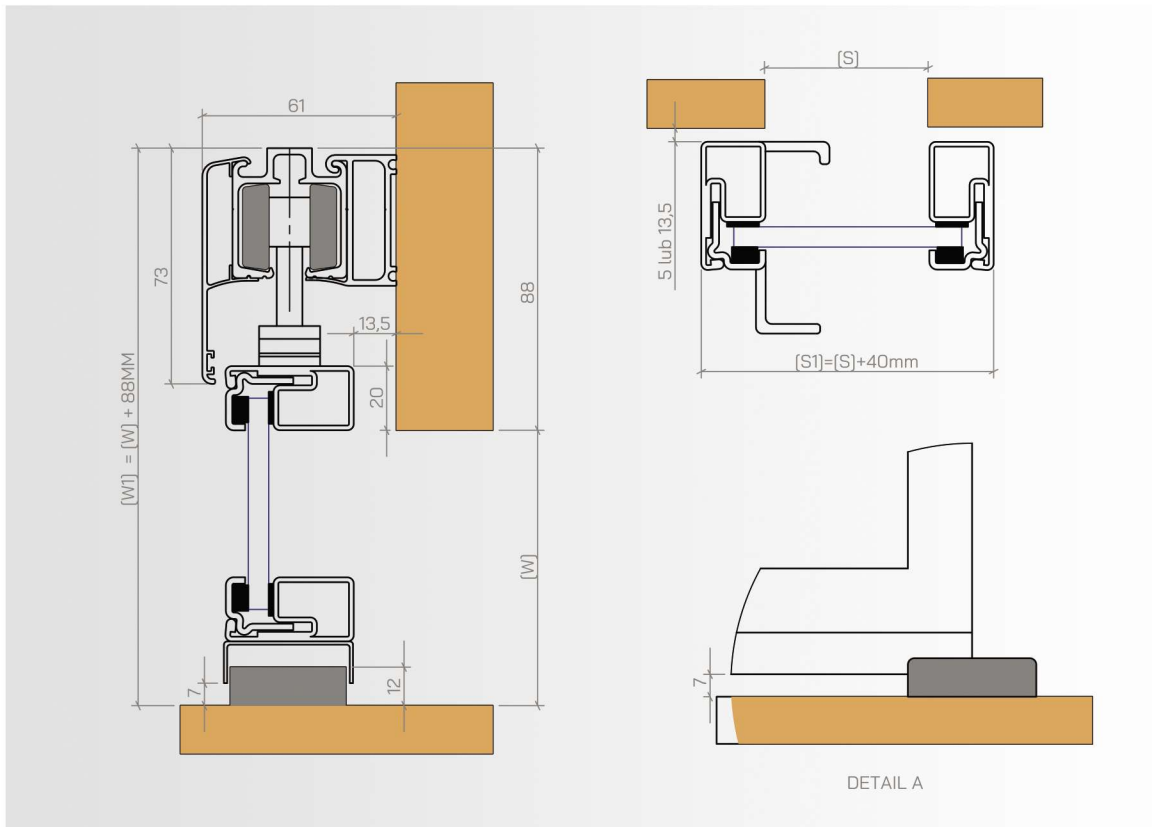

PORTE COULISSANTE LOFT ART

Montage au mur

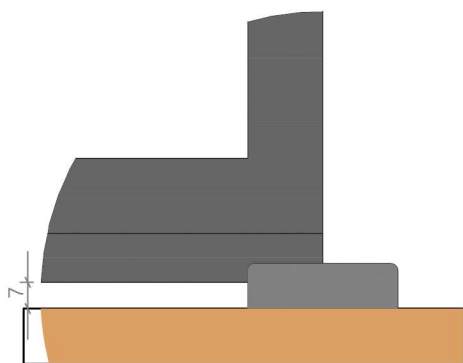
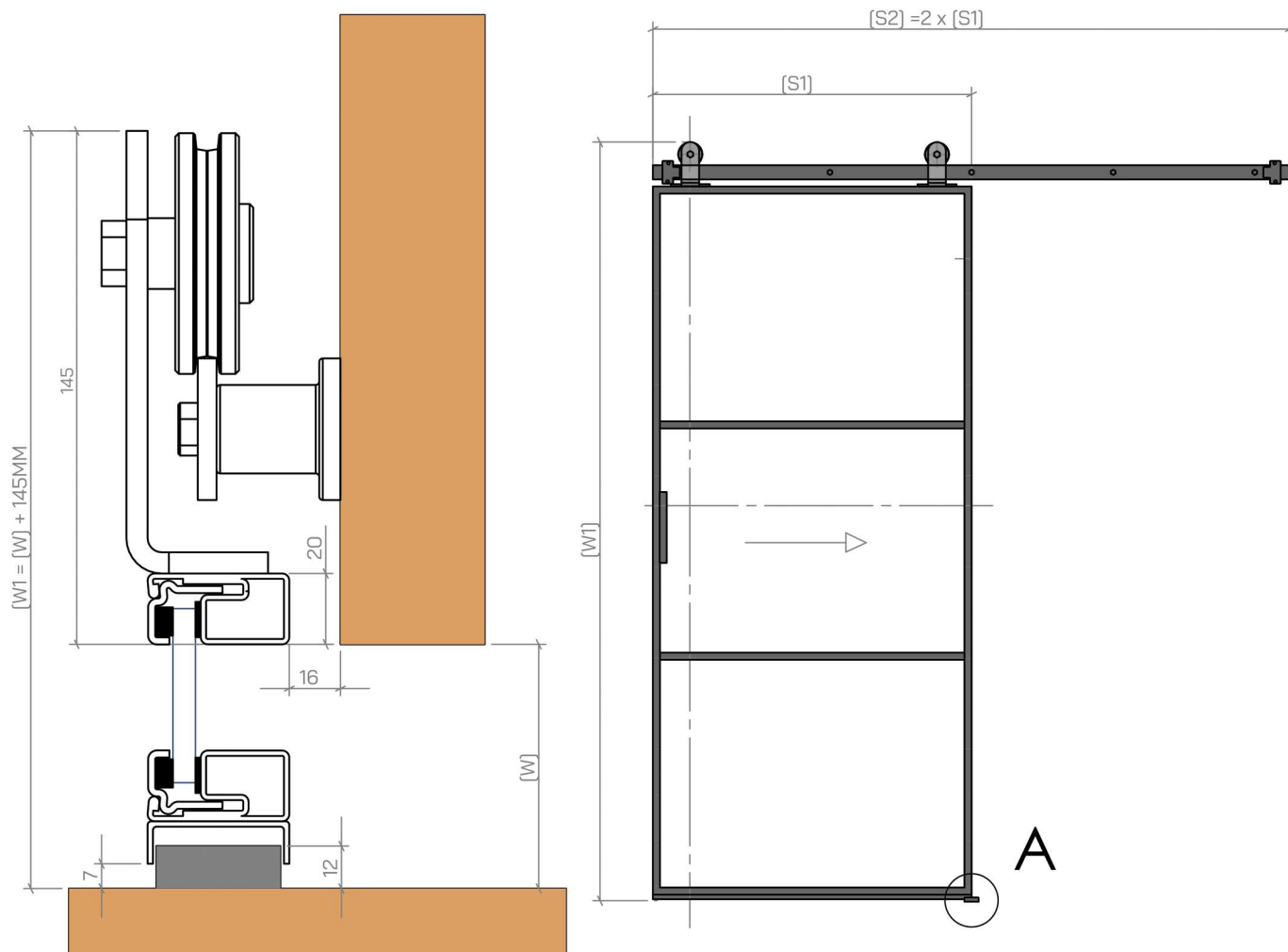

DETAIL A

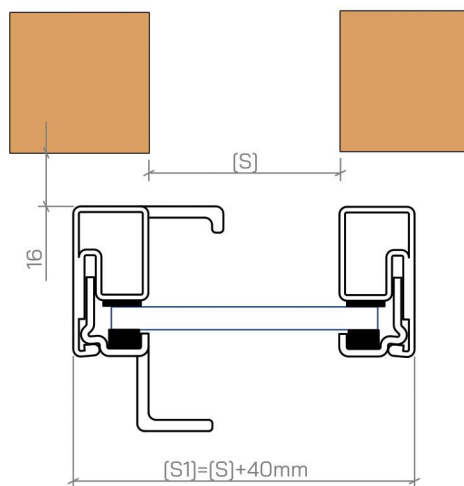

■ PORTE COULISSANTE AVEC UN IMPOSTE FIXE LATÉRALE

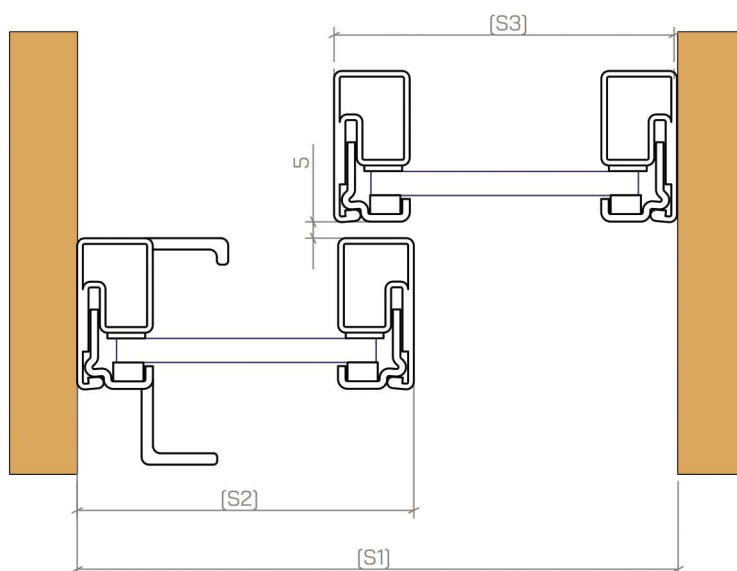
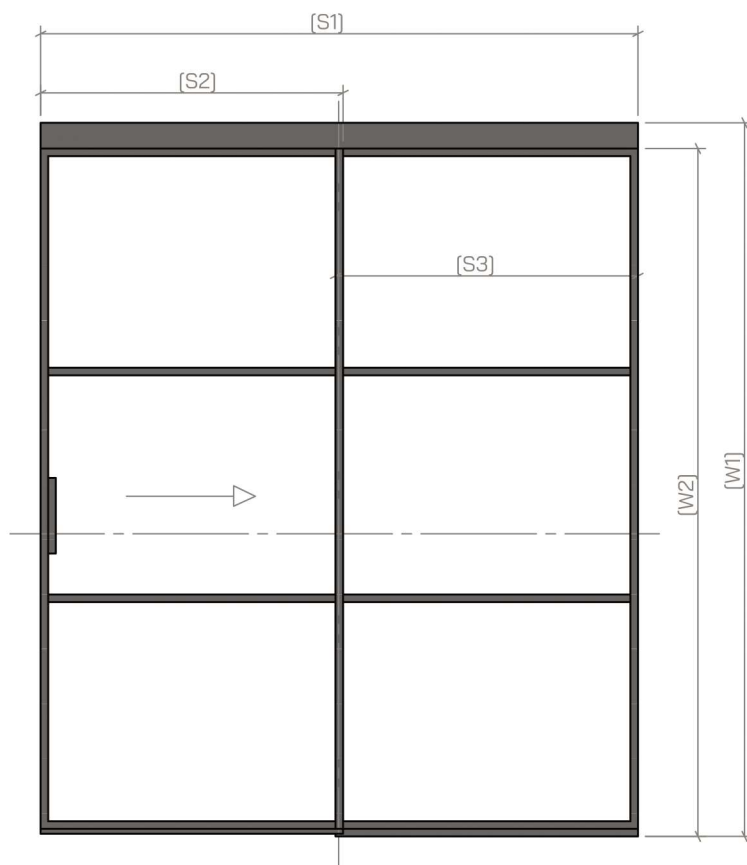
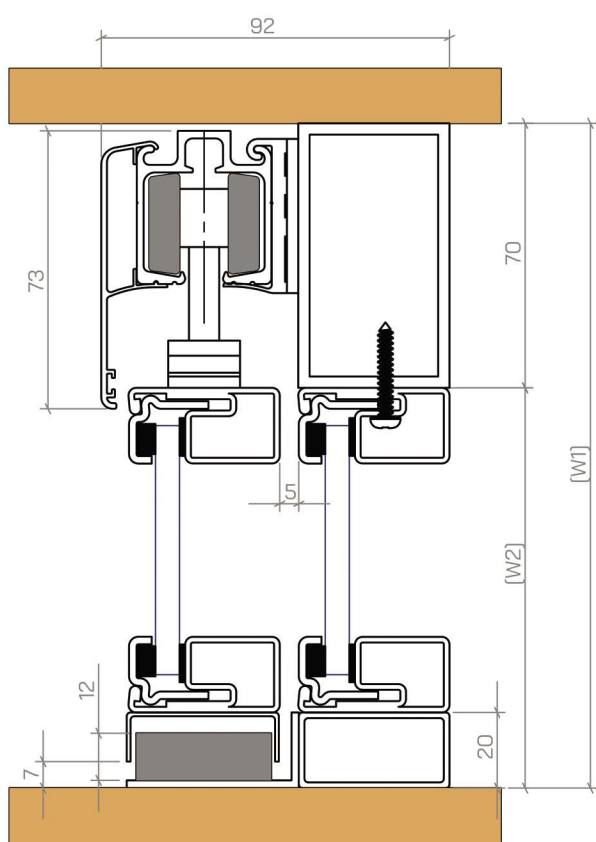

POORTE COULISSANTE AVEC UN IMPOSTE HORIZONTAL

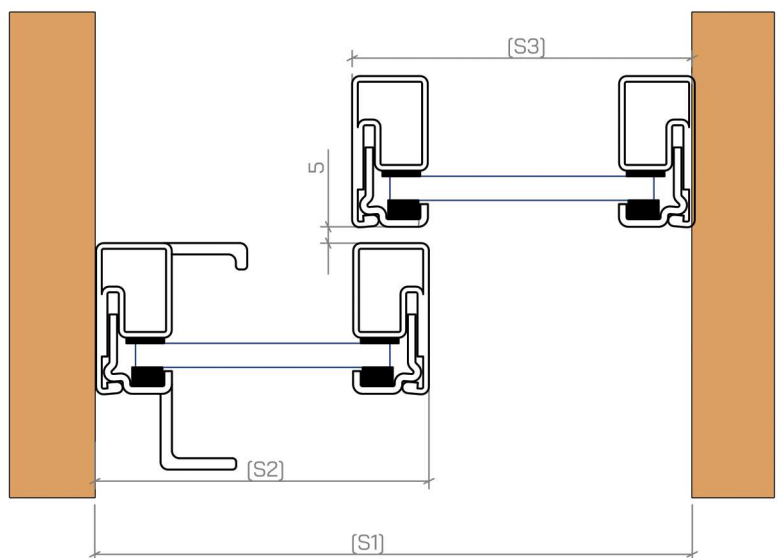
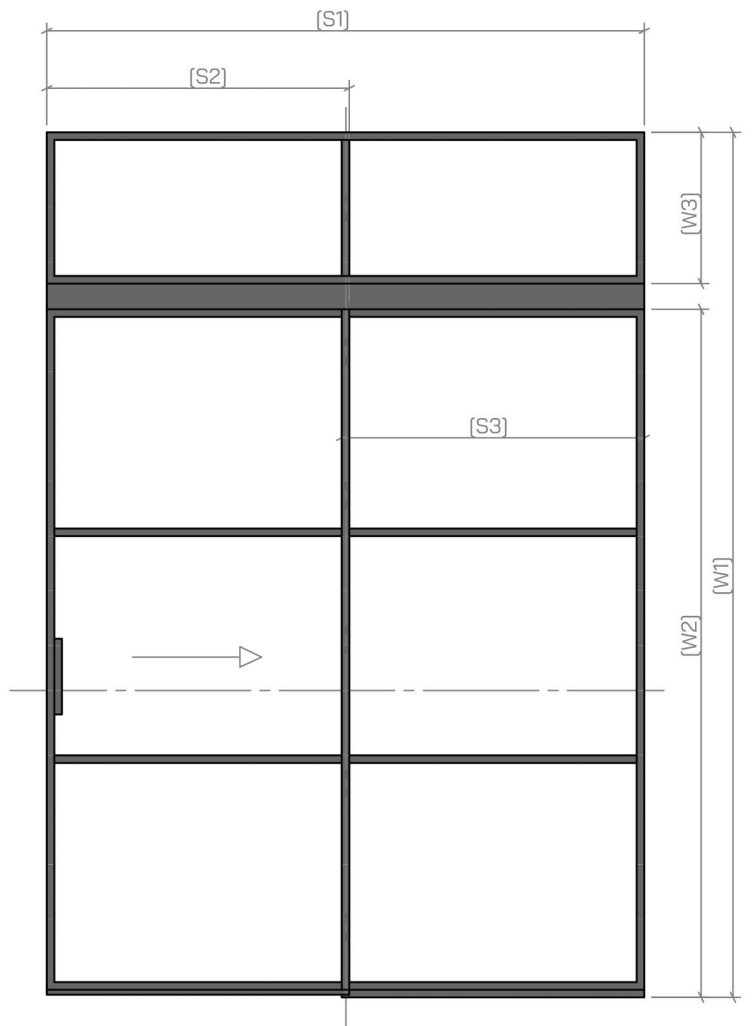
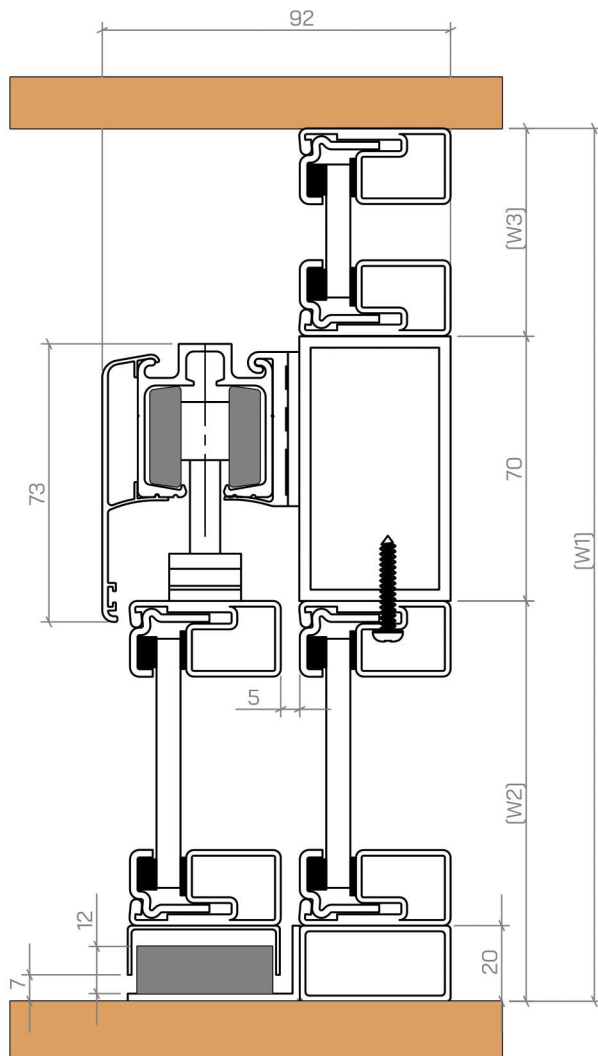

■ SYSTÈME DE PORTE COULISSANTE

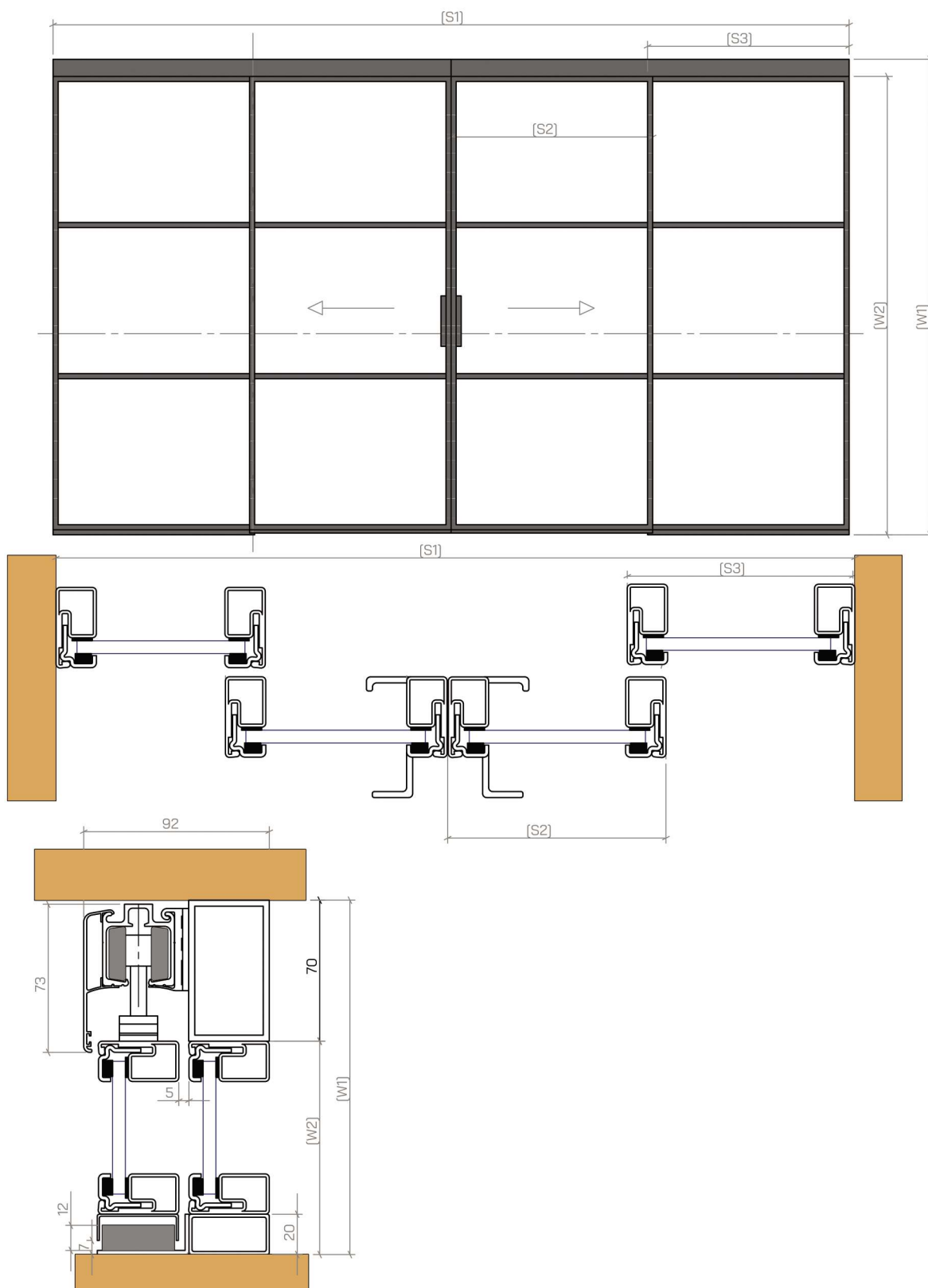

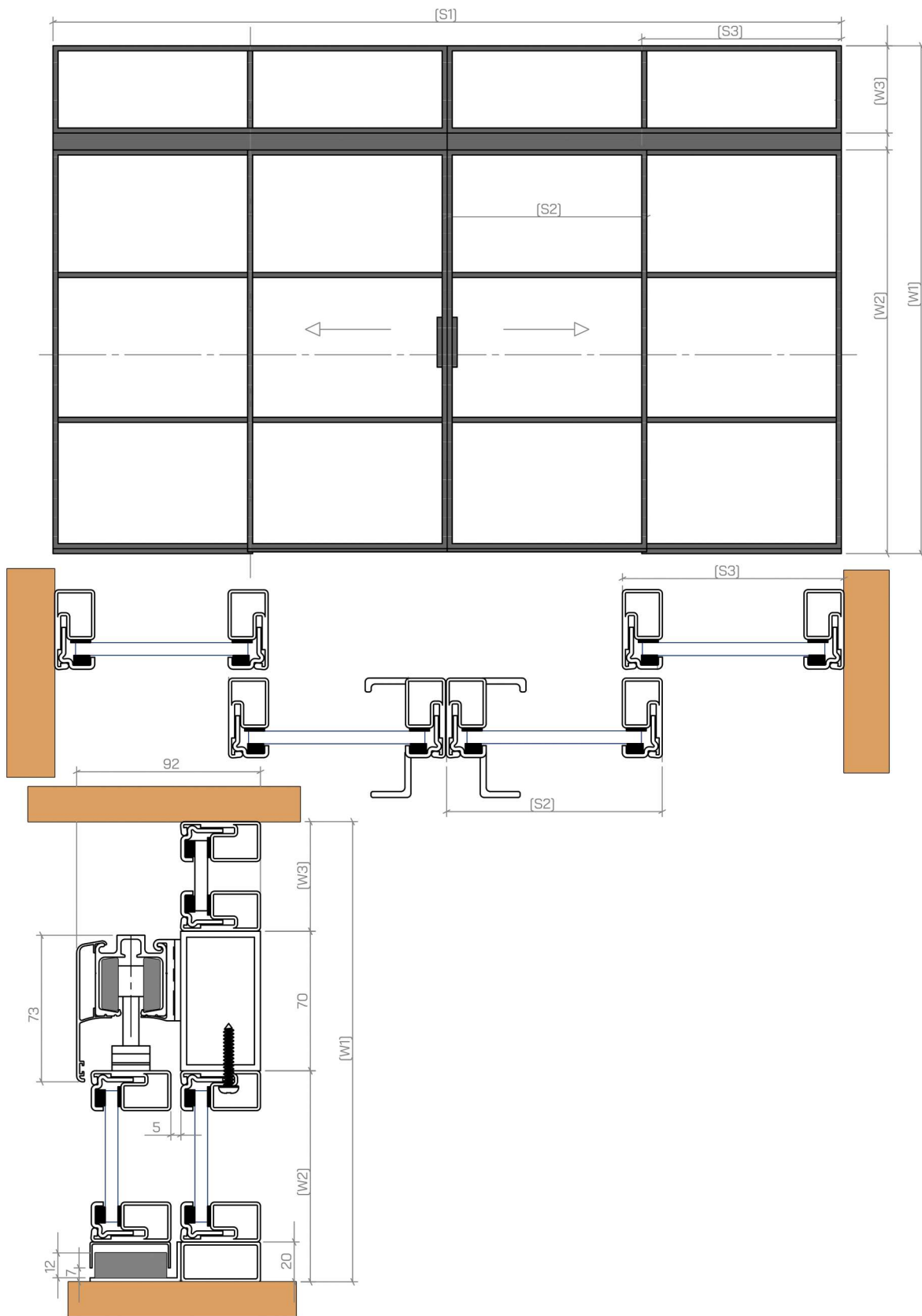

■ PORTE COULISSANTE A GALENDAGE

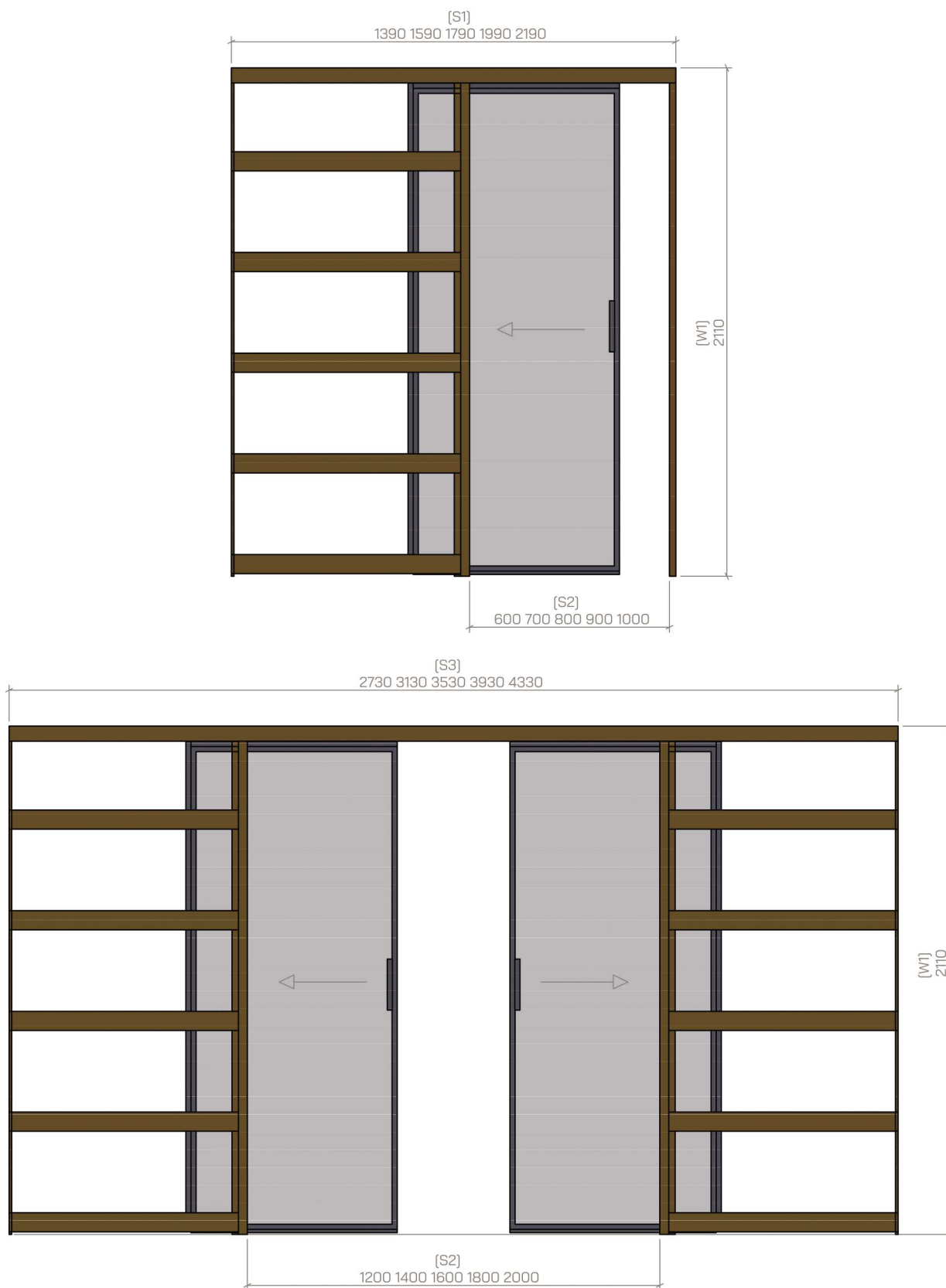

PORTE BATTANTE

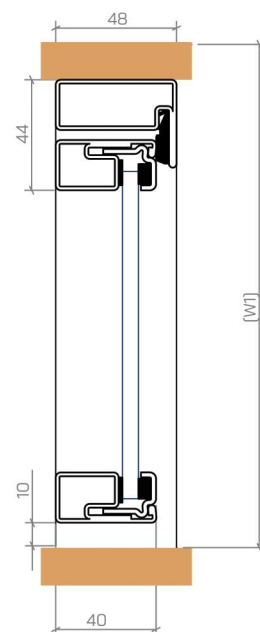
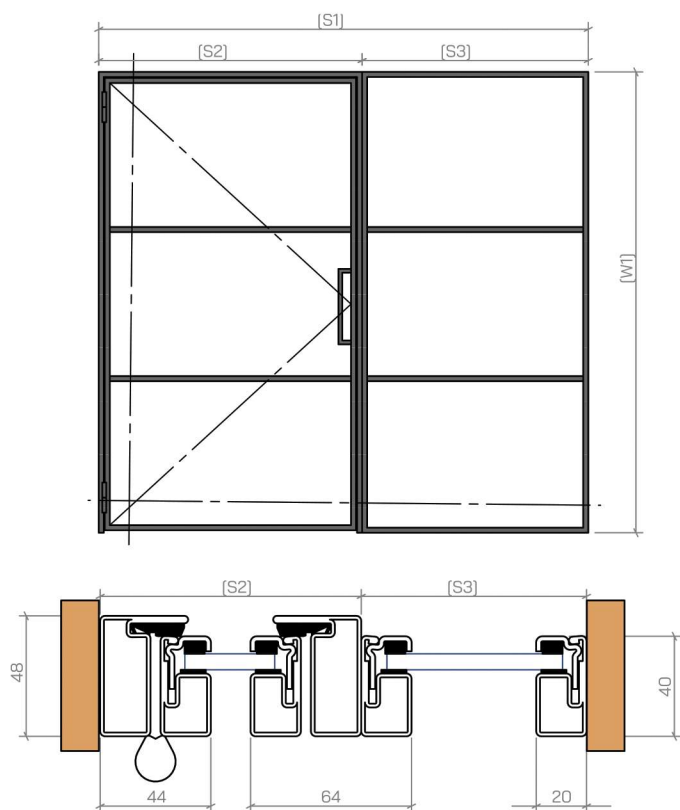
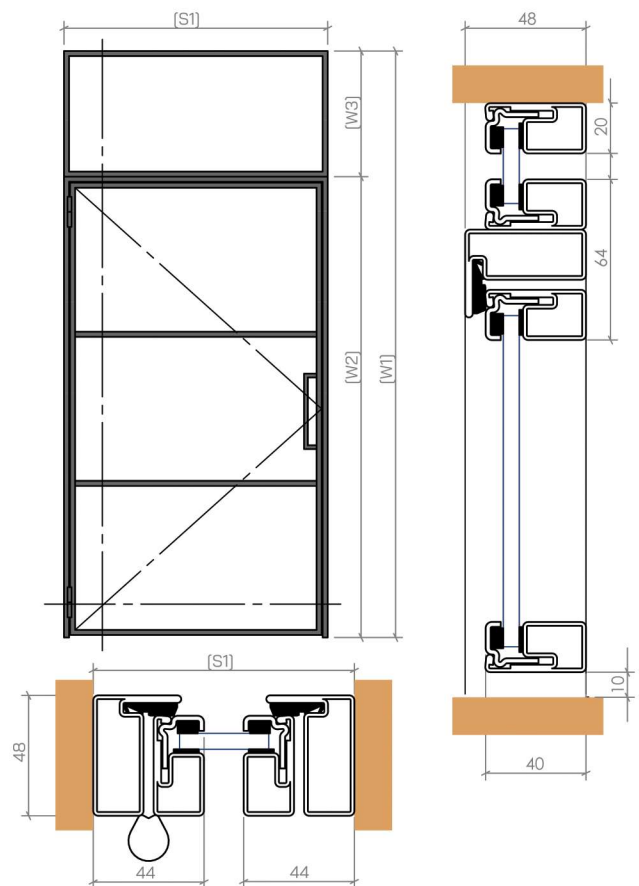
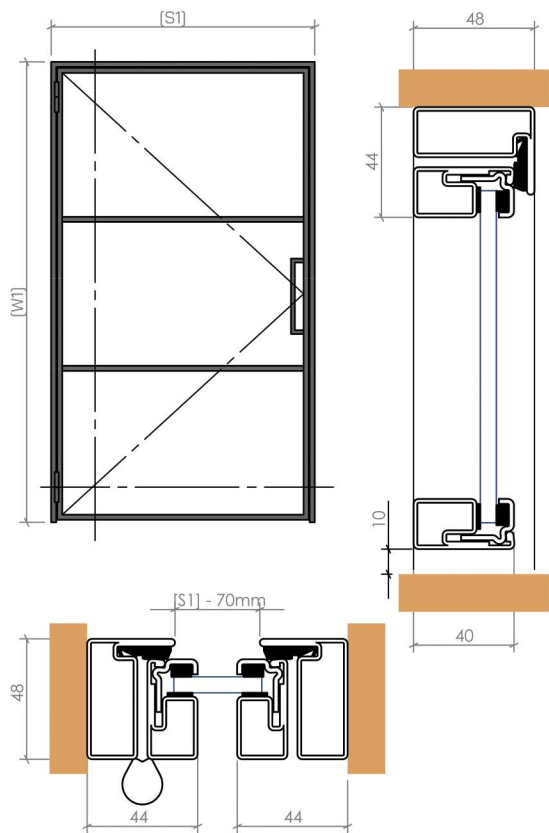

■ PORTE BATTANTE / UN ENSEMBLE

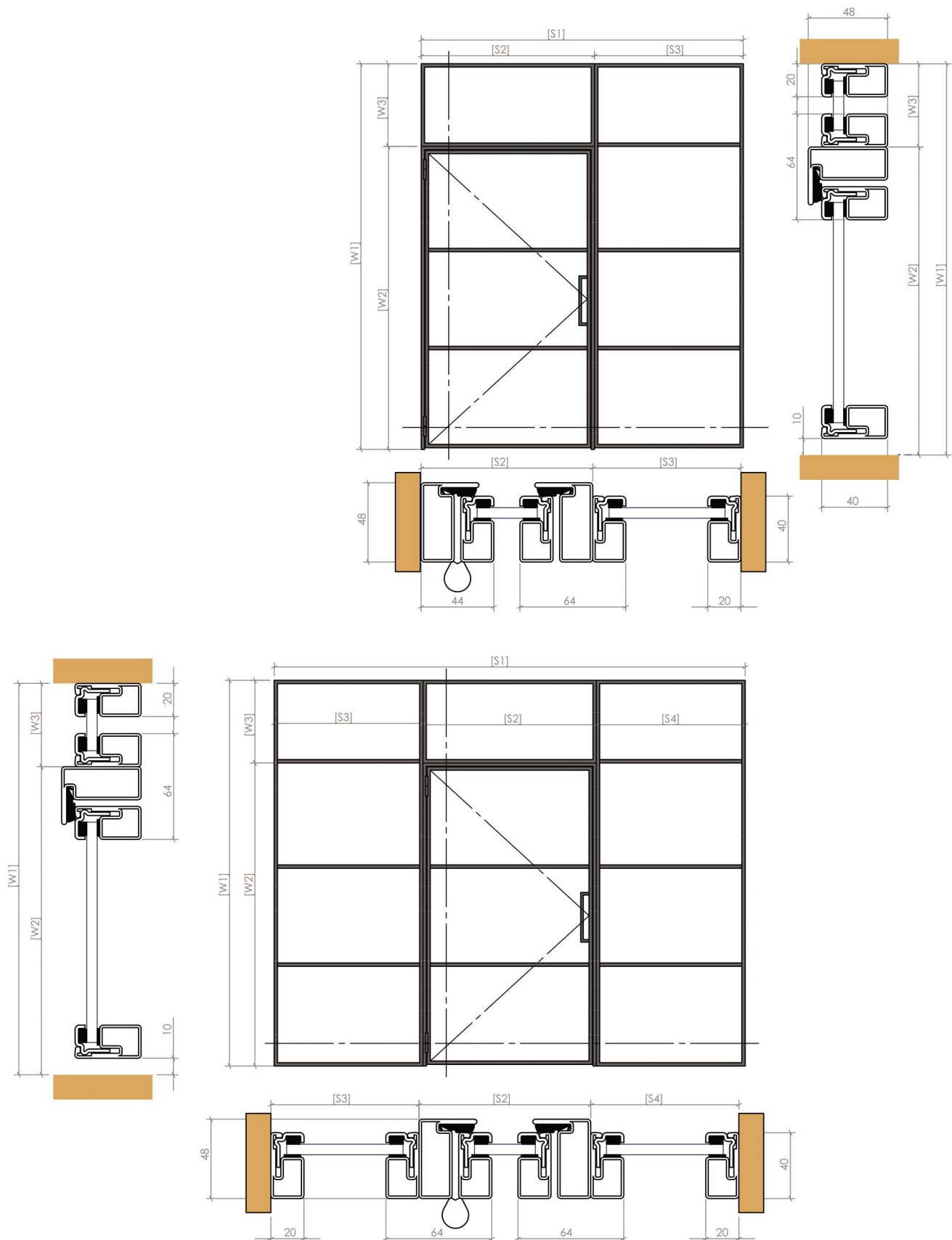

LA DOUBLE PORTE BATTANTE /DEUX VENTAUX

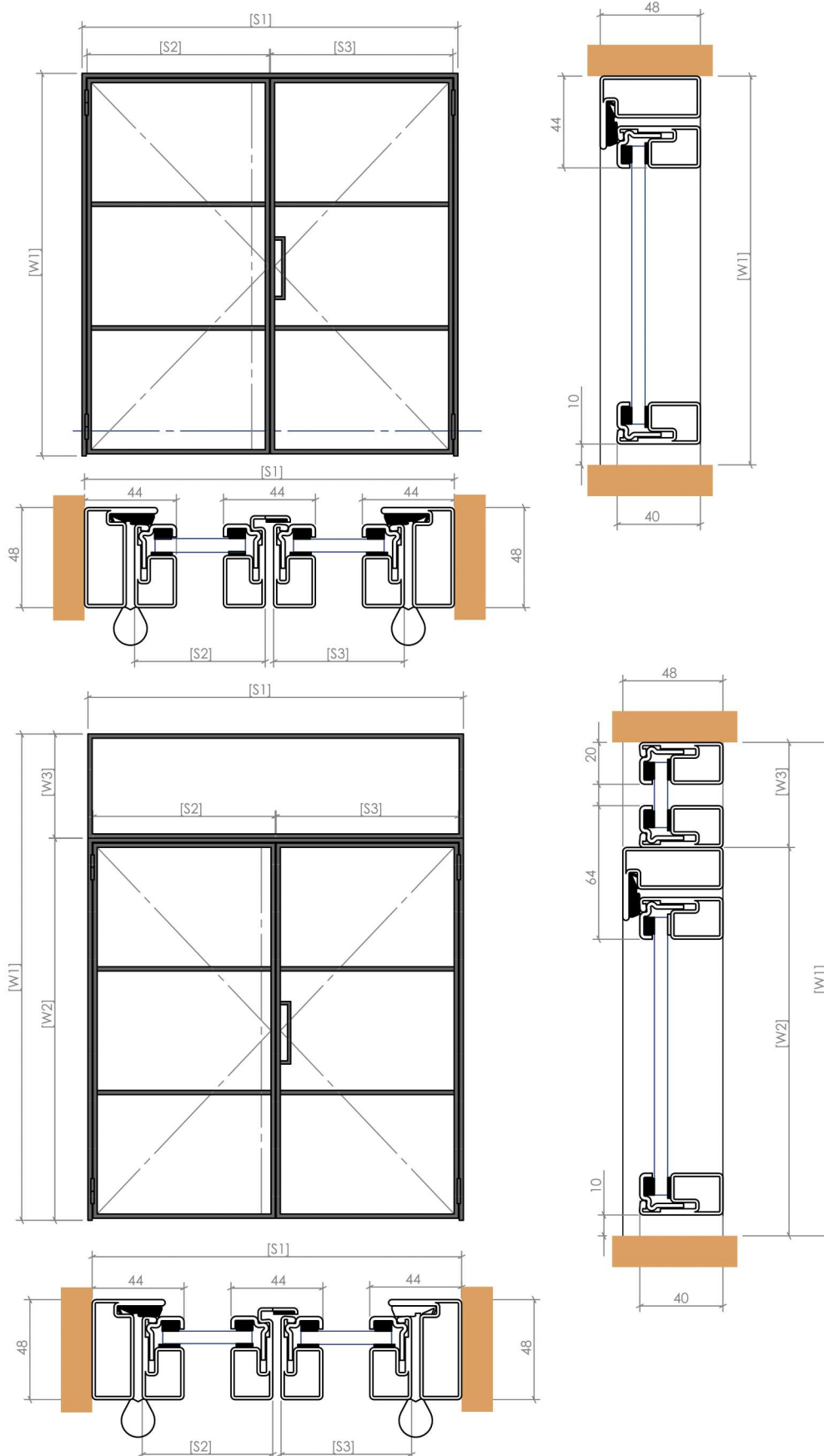

LA DOUBLE PORTE BATTANTE /UN ENSEMBLE

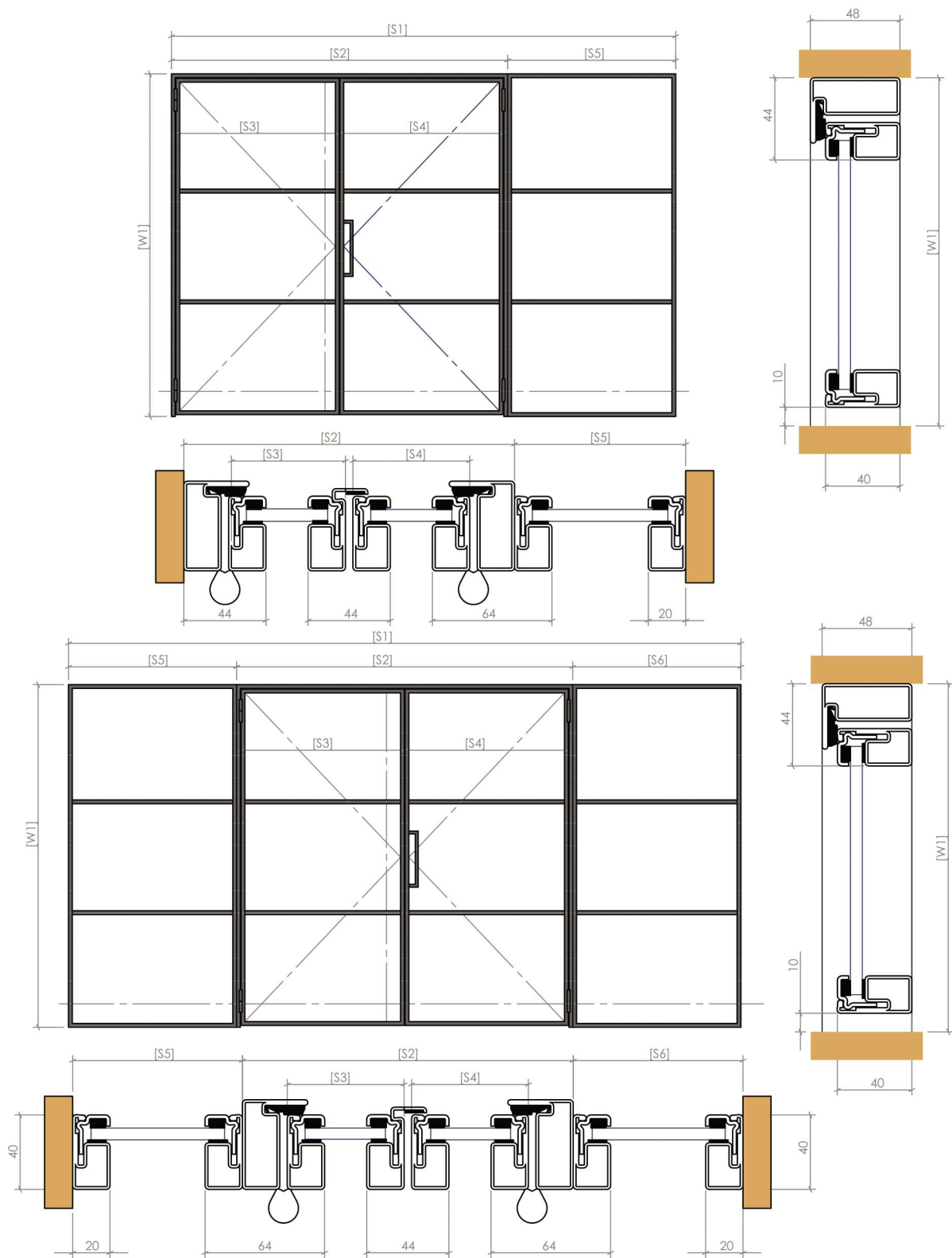

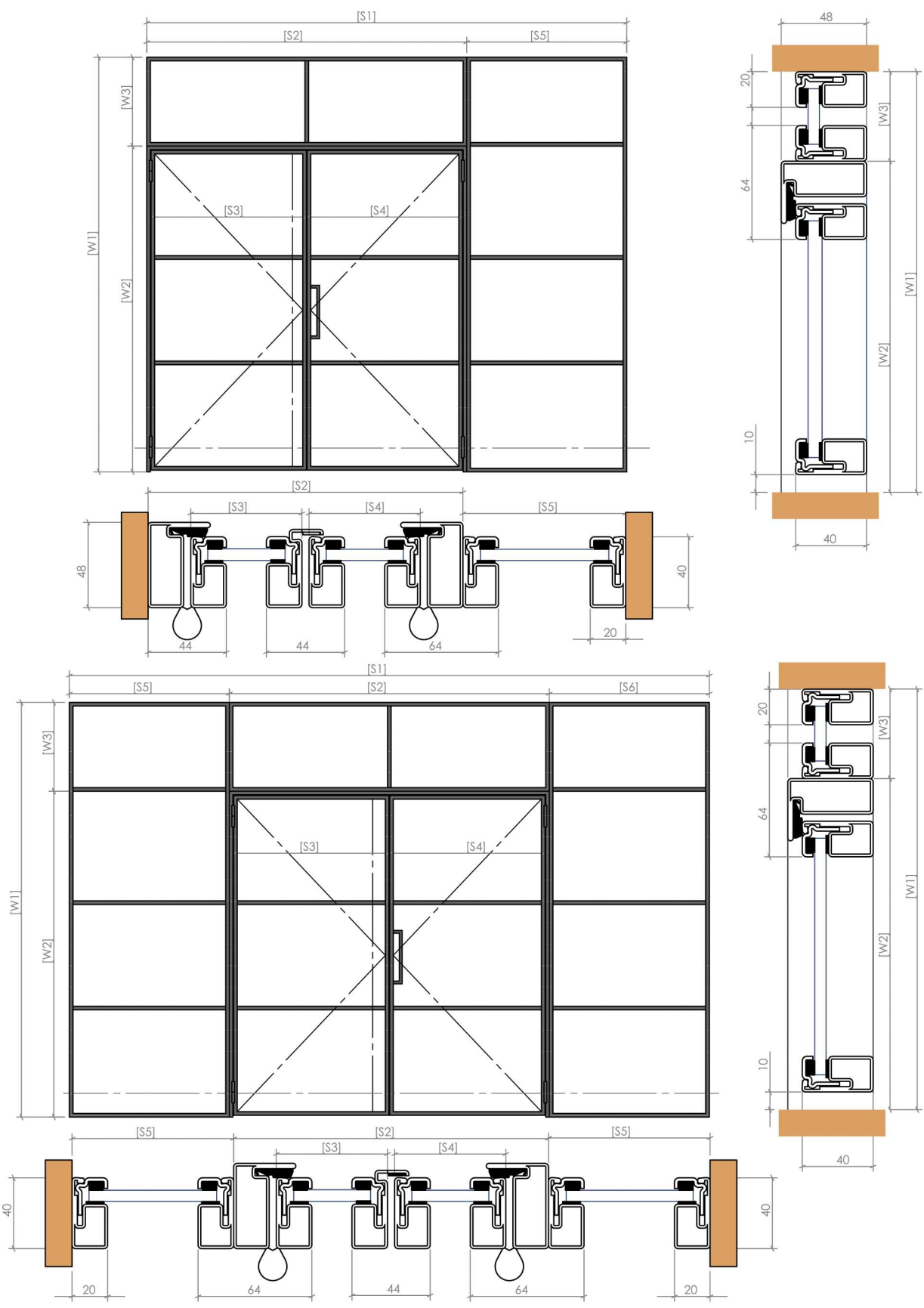

■ PORTE PIVOTANTE

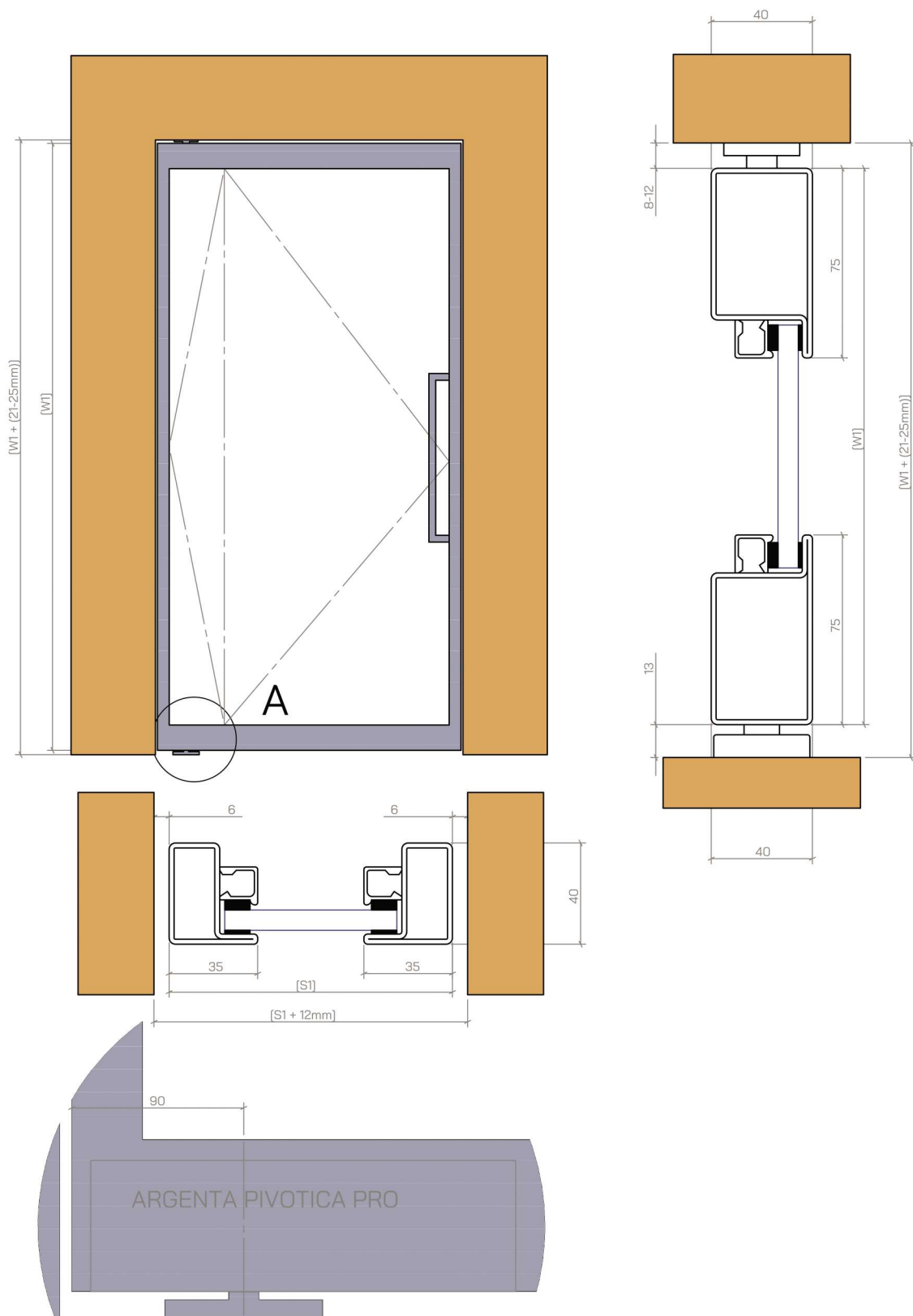

POORTE PLIANTE

sans seuil

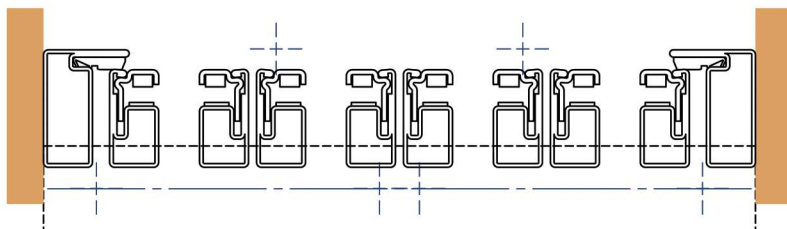
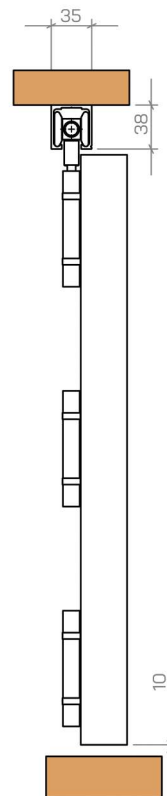
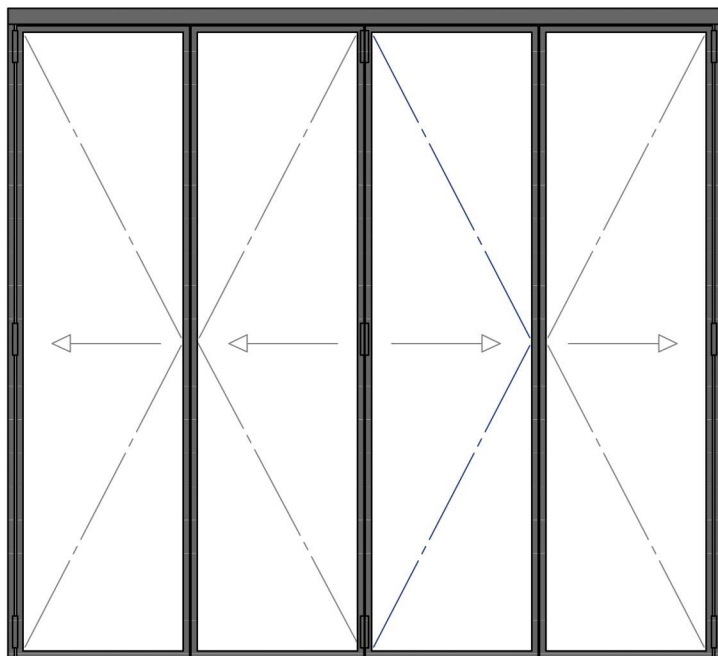

CHARGE MAX 100KG
/UN VENTAIL

SOLUTION POSSIBLE

- | | | | |
|-------|--|-------|--|
| 2L | | 1L 3P | |
| 2L 1P | | 1L 2P | |
| 3L | | 1L 4P | |
| 3L 1P | | 4P | |
| 4L | | 3L 3P | |
| 4L 1P | | 4L 3P | |
| 3L 2P | | 3L 4P | |
| 2P | | 2L 3P | |
| 1L 2P | | | |
| 3P | | | |

■ PORTE PLIANTE AVEC UN SEUIL

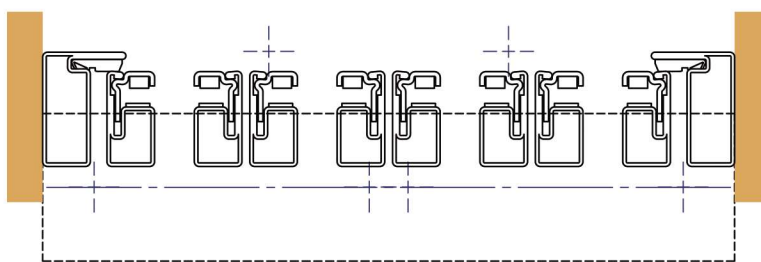
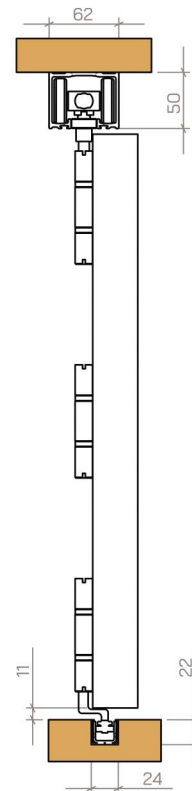
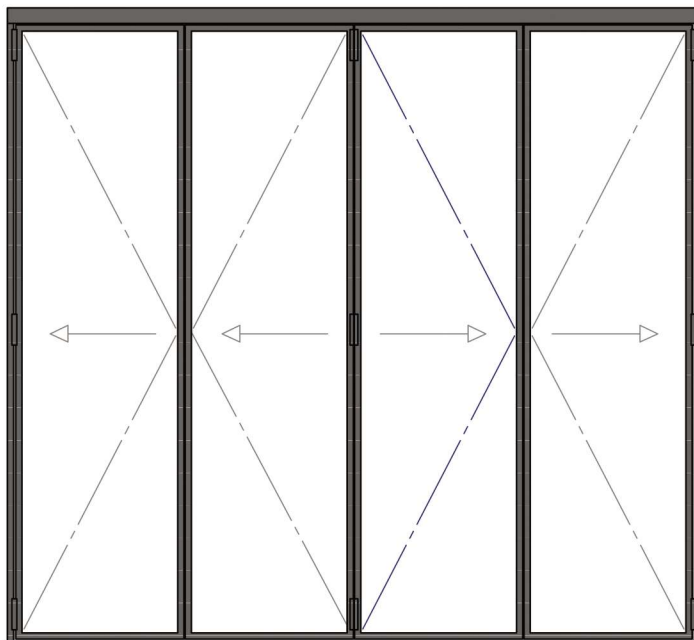

CHARGE MAX 100KG
/UN VENTAIL

SOLUTION POSSIBLE

2L		5L	
2L 1P		3L 3P	
3L		7L	
3L 1P		4L 3P	
4L		5L 2P	
4L 1P		5L 3P	
3L 2P		2L 3P	
2P		5P	
1L 2P		3L 4P	
3L		7P	
1L 3P		2L 5P	
2L 2P		8P	
1L 4P			
4P			

■ INSTALLATION D 'UN PAROIS /MUR FIXE

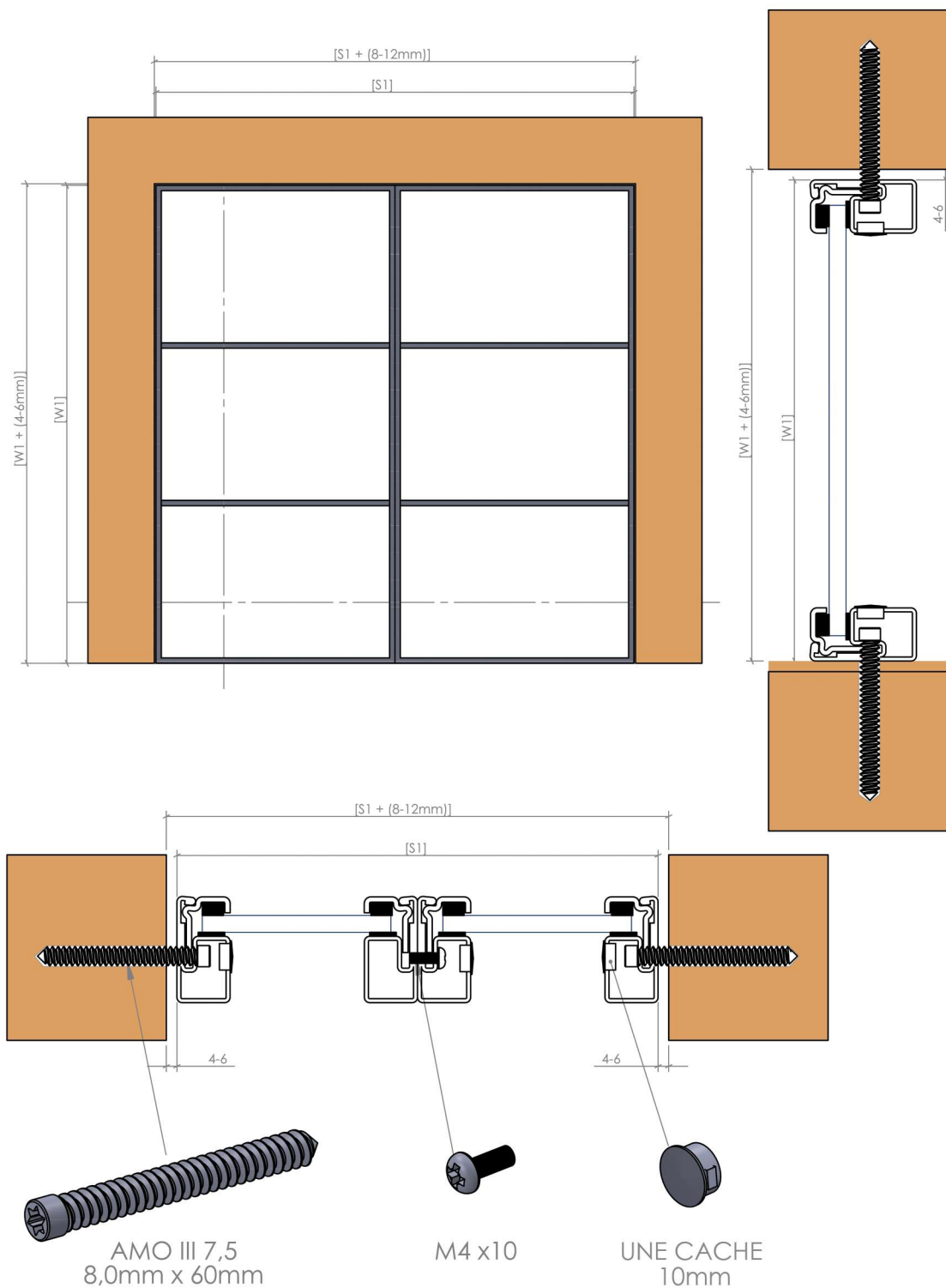

MONTAGE DES PORTES BATTANTES

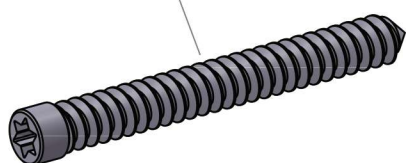
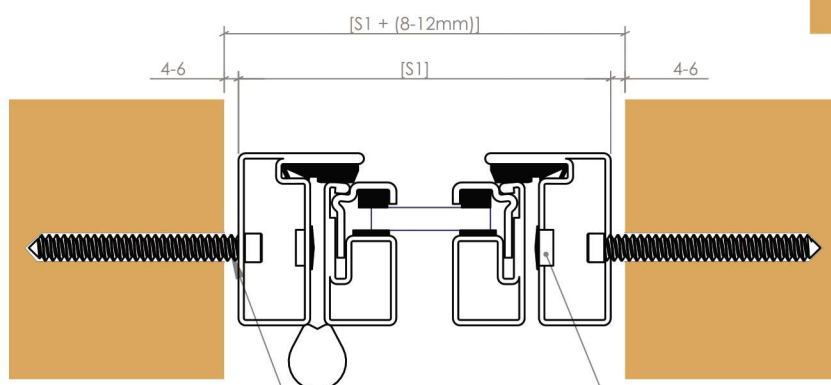
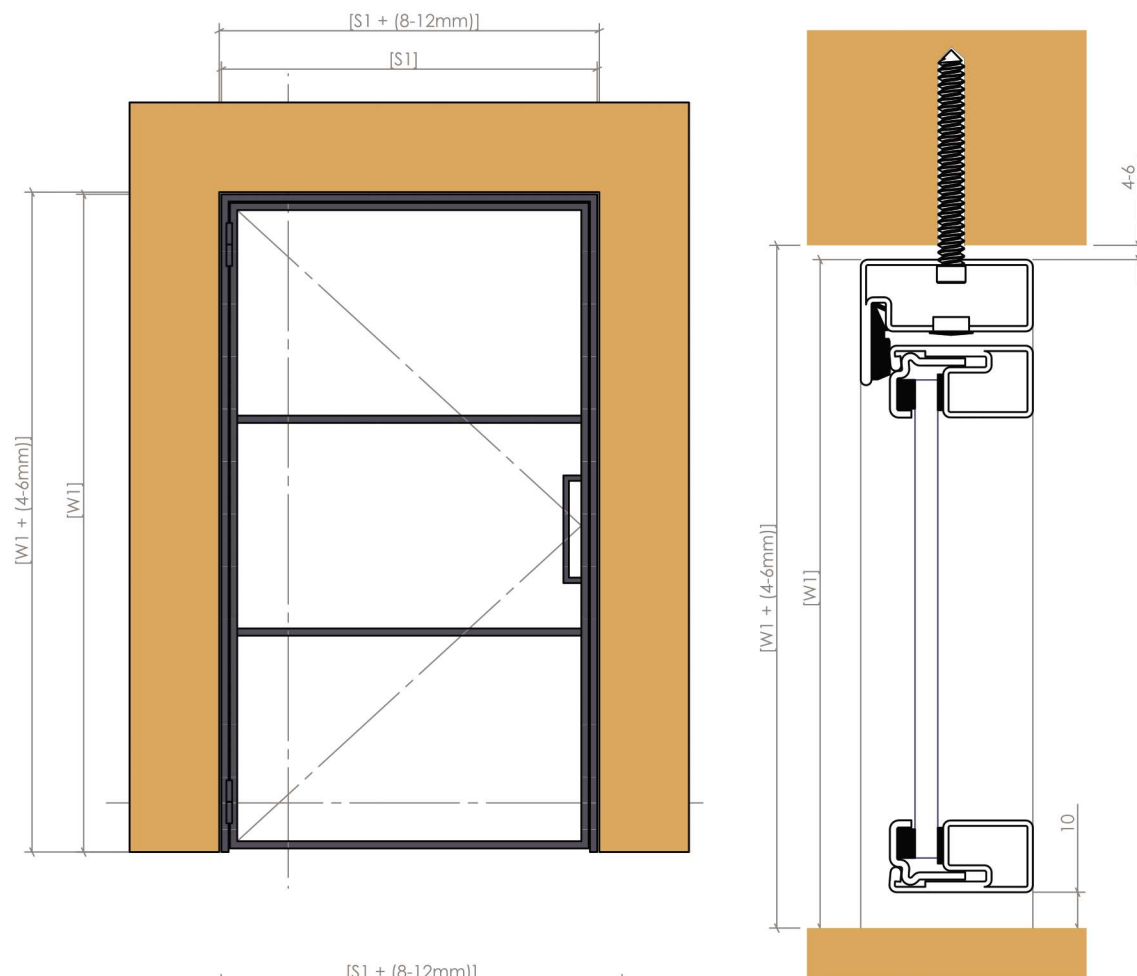

WURTH AMO III 7,5
8,0mm x 60mm



UNE CACHE
10mm

■ MONTAGE DES PORTES BATTANTES

avec un imposte Latérale et avec des impostes horizontaux

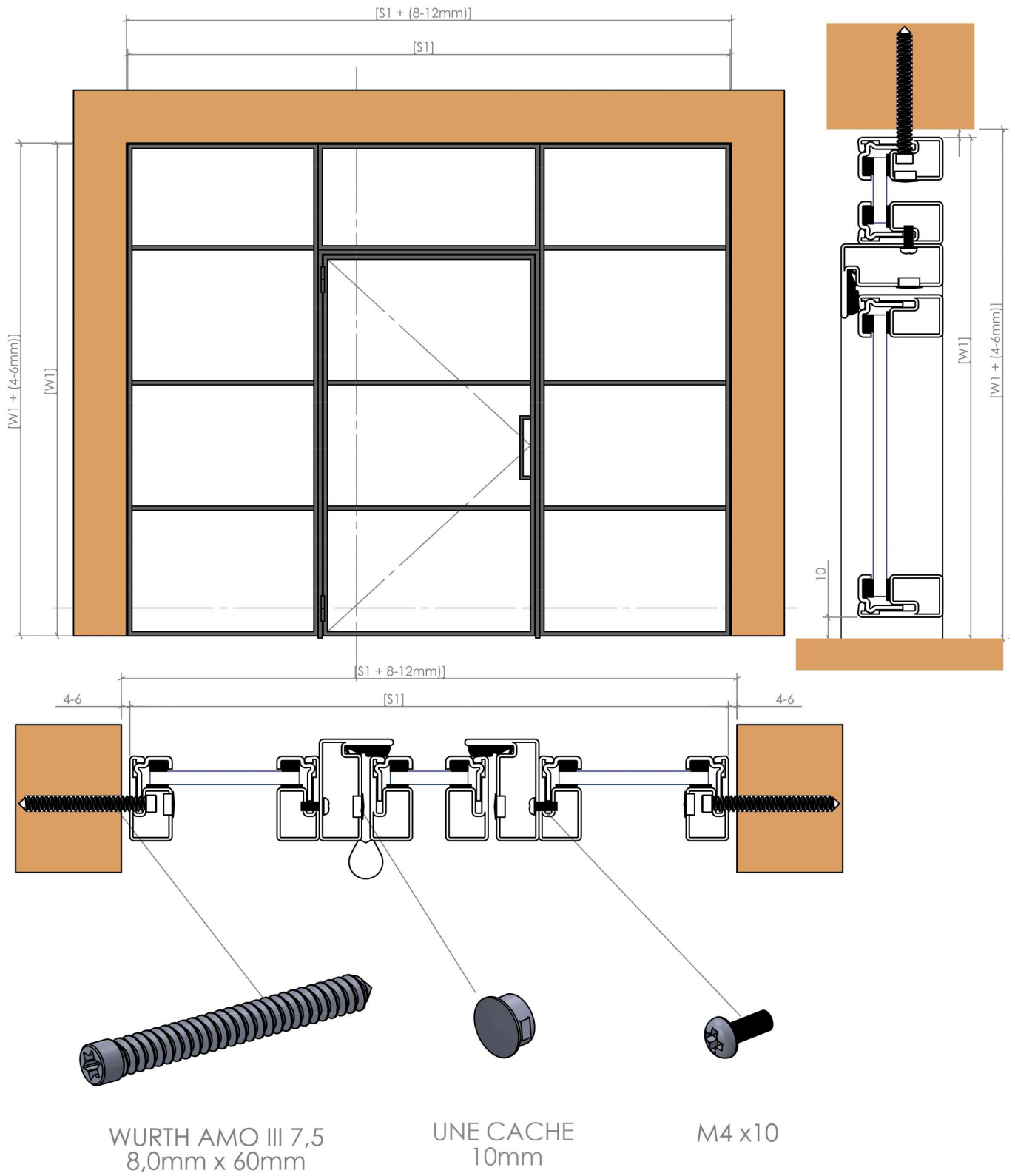

■ ASSEMBLAGE DES ANGLES DE L'EXT

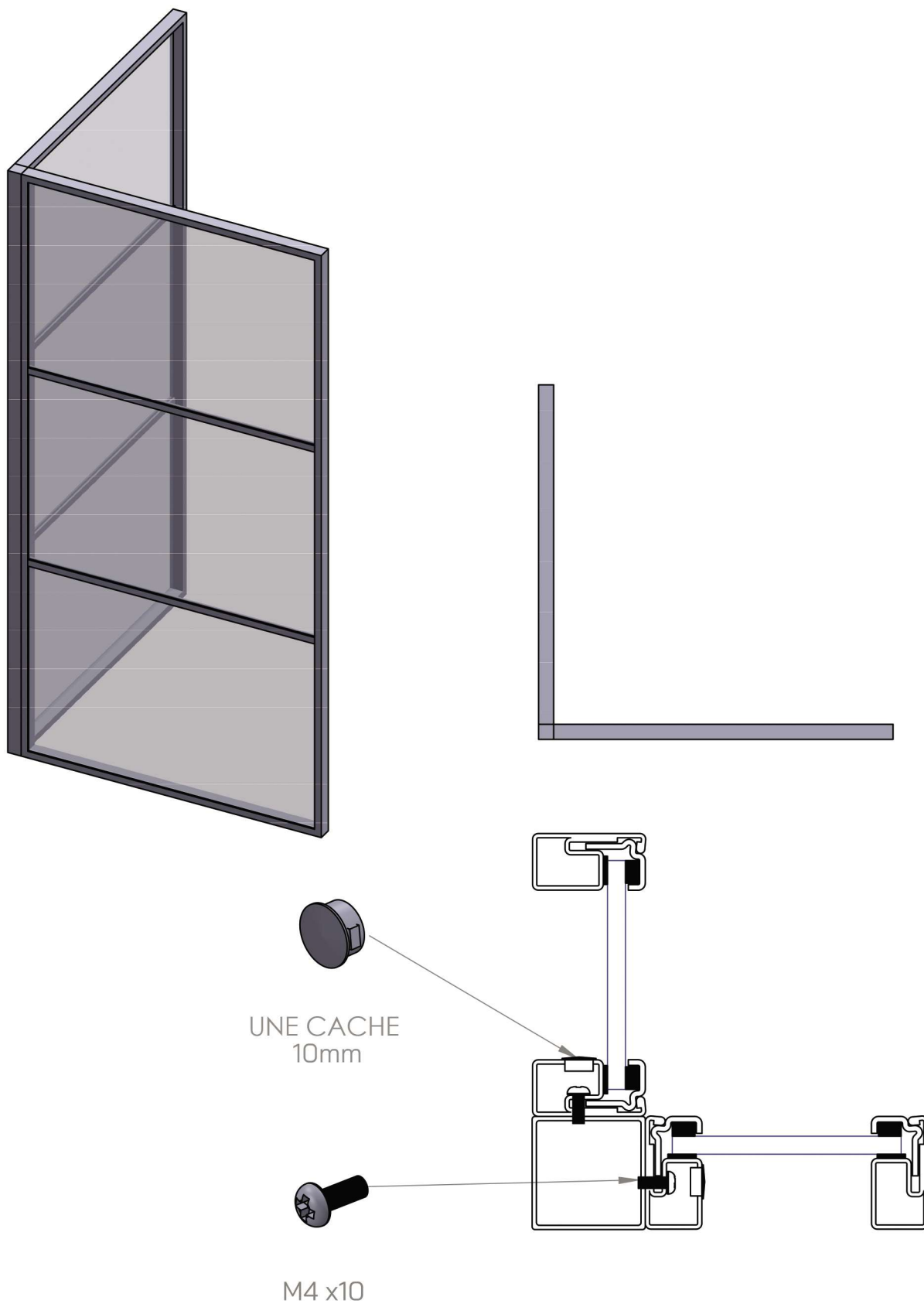

■ TYPES D'ÉMAILLAGE



ESG PARSOL GRIS



ESG SATINOVO

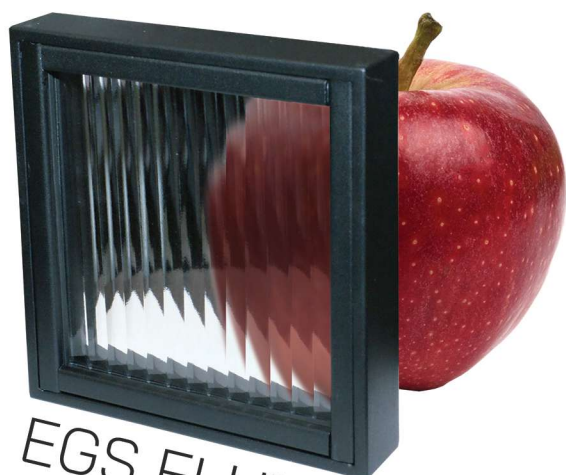

EGS FLUTES

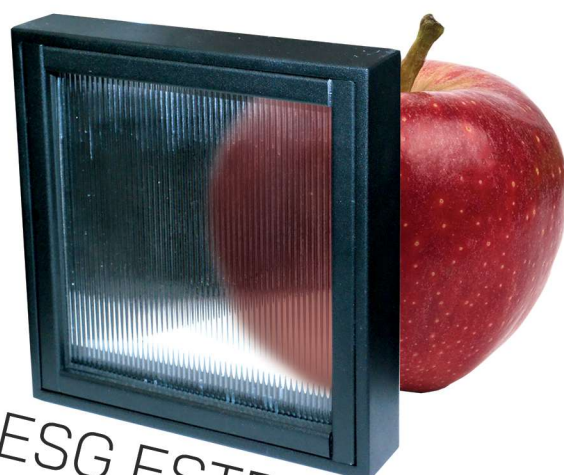

ESG ESTRIADO



VSG 33.1 MAT

MURS FIXES

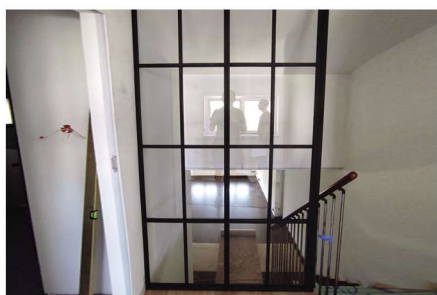
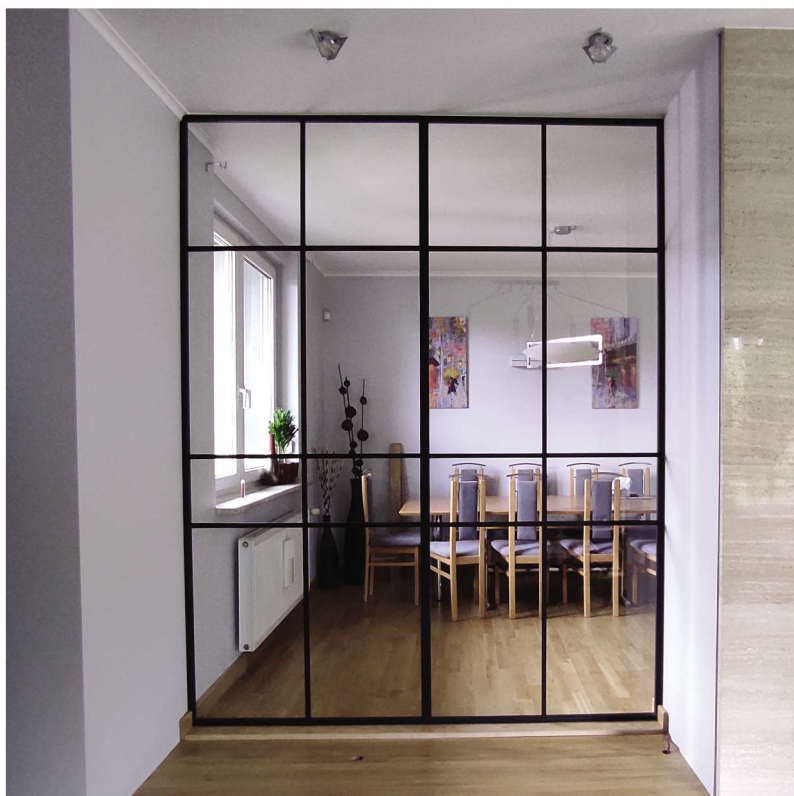

■ PORTE BATTANTE SIMPLE

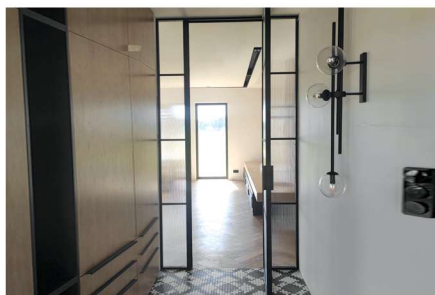
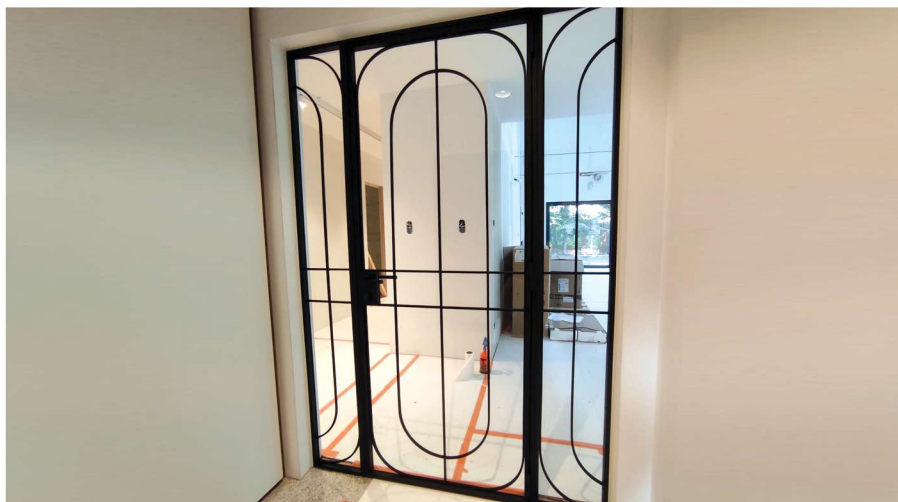

DOUBLE PORTE BATTANTE



ENSEMBLES DE PORTES BATTANTES

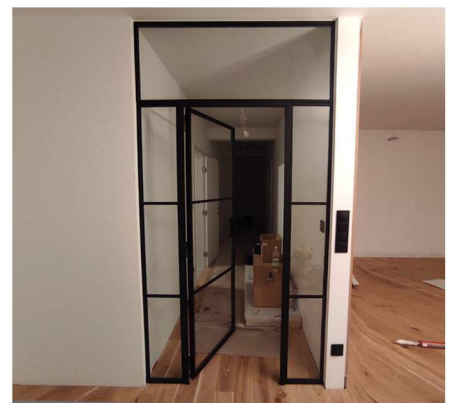
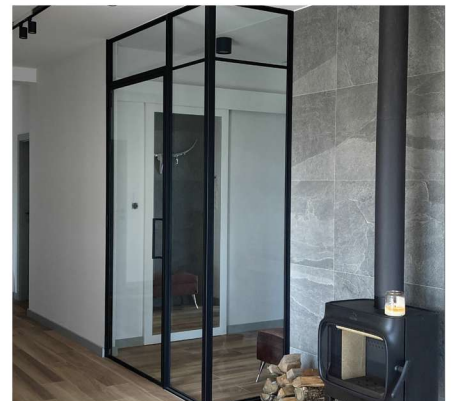

PORTES COULISSANTES

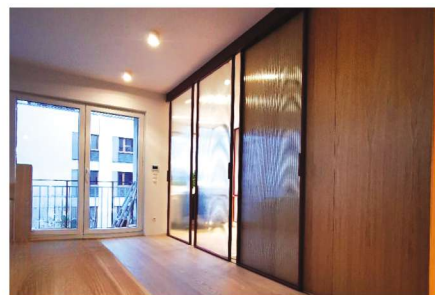
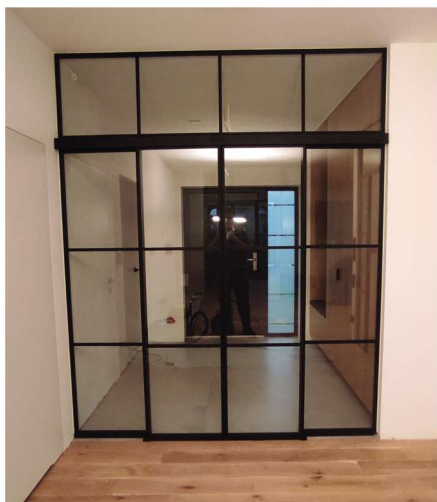

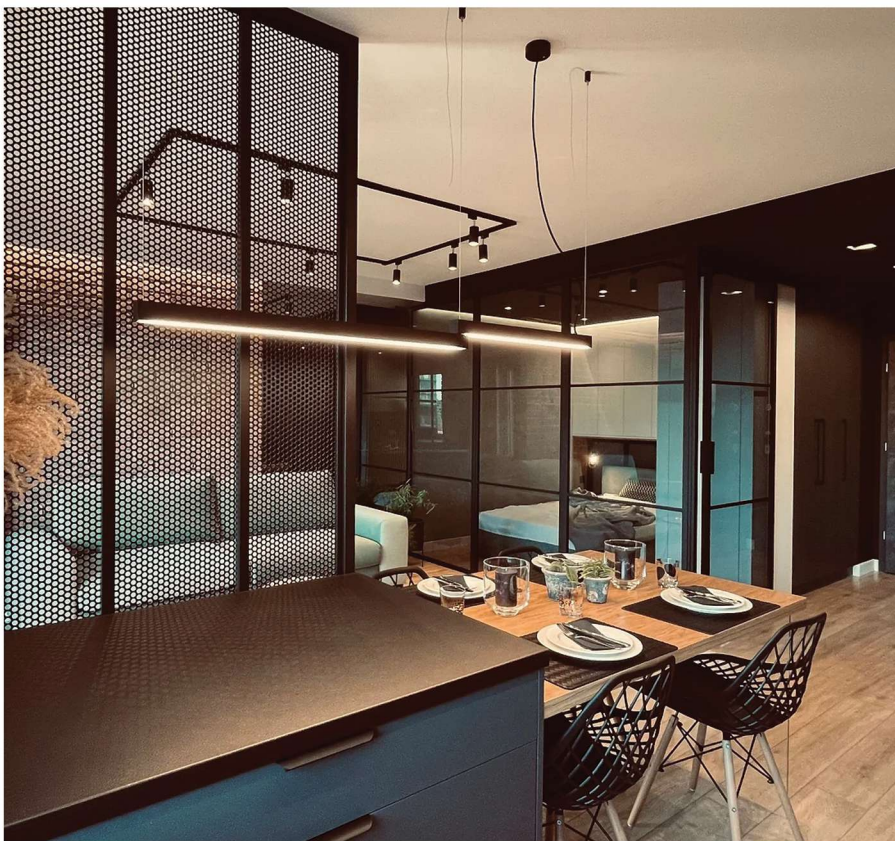
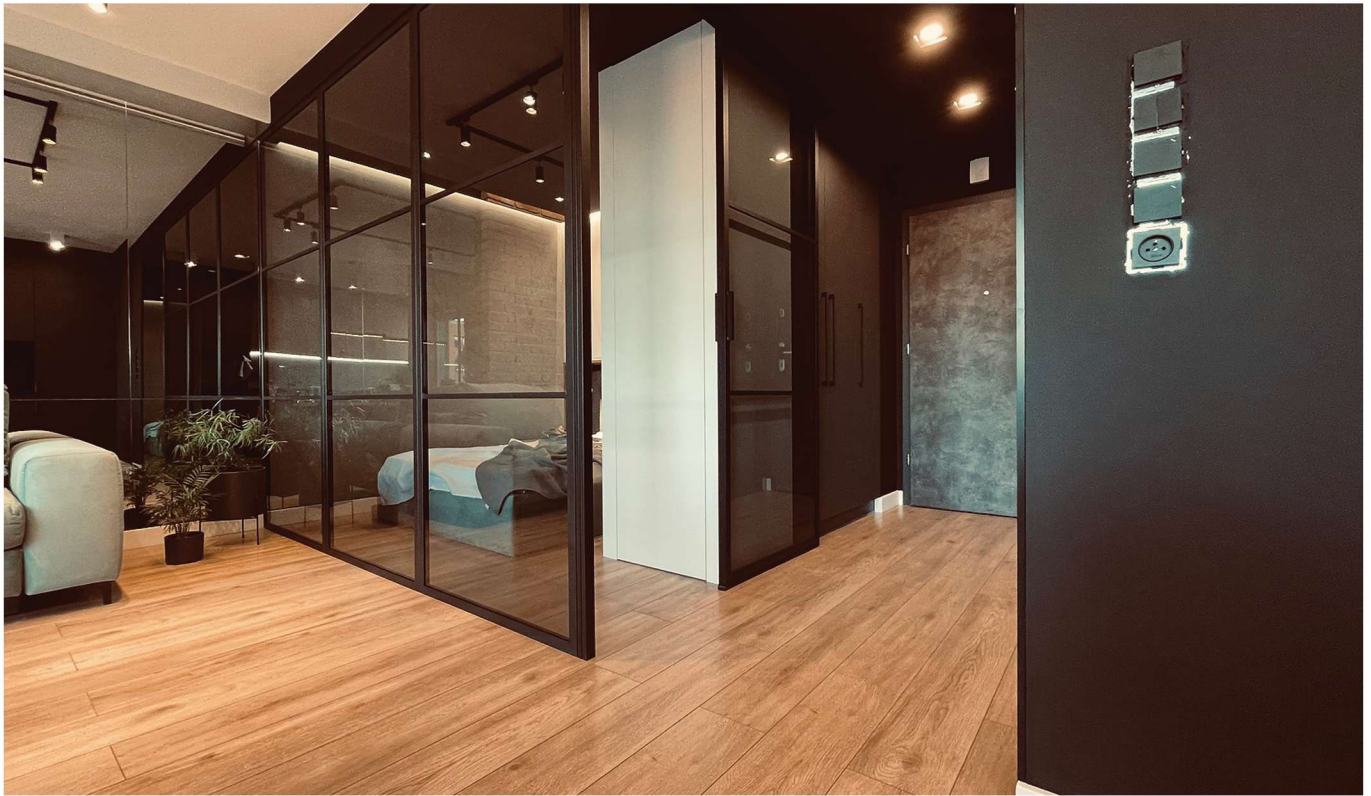

PORTES PLIANTES

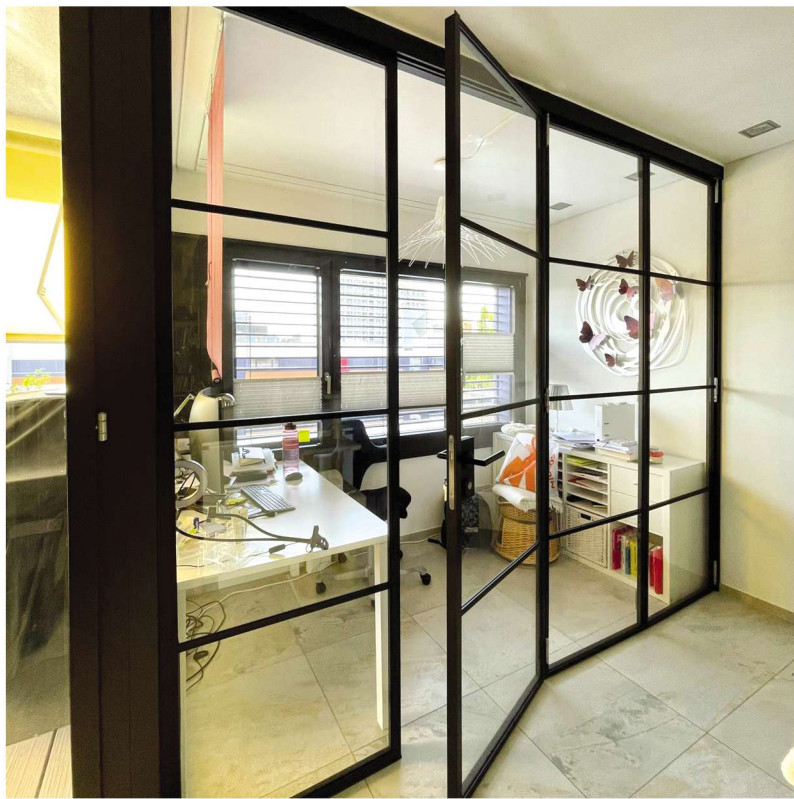

POIGNÉES



PRODUCTION



